

# AGENDA

## University of Connecticut Board of Trustees

### Financial Affairs Committee December 10, 2024, at 10:00 a.m. Virtual Meeting

Public Streaming Link (with live captioning upon request): <https://ait.uconn.edu/bot>

*(A recording of the meeting will be posted on the Board website <https://boardoftrustees.uconn.edu/> within seven days of the meeting.)*

Call to order at **10:00 a.m.**

1) Public Participation\*

\*Individuals who wish to speak during the Public Participation portion of the Tuesday, December 10, meeting must do so 24 hours in advance of the meeting's start time (i.e., 10:00 a.m. on Monday, December 9) by emailing [BoardCommittees@uconn.edu](mailto:BoardCommittees@uconn.edu). Speaking requests must include a name, telephone number, topic, and affiliation with the University (i.e., student, employee, member of the public). The Committee may limit the entirety of public comment to a maximum of 30 minutes. As an alternative, individuals may submit written comments to the Committee via email ([BoardCommittees@uconn.edu](mailto:BoardCommittees@uconn.edu)), and all comments will be transmitted to the Committee.

**ACTION/PRESENTATION ITEMS:**

**TAB**

- |   |   |
|---|---|
| 2) Minutes of the October 24, 2024, Meeting   | 1 |
| 3) Contracts and Agreements for Approval  | 2 |
| 4) FY25 UConn and UConn Health Budget Update  | 3 |
| 5) Academic Year 2025/26 Student Fees for the University of Connecticut, Storrs and Regional Campuses   | 4 |
| 6) School of Dental Medicine Tuition and Fees Rates for Academic Years 2026 and 2027  | 5 |
| 7) Authorization to Execute Firm Electricity Purchase Contracts Resulting from Competitive Pricing Solicitation   | 6 |
| 8) Cooperation Agreement with Wilhusky Housing LLC concerning development of Site B of off-campus student housing known as The Hub on North Eagleville Road | 7 |
| 9) Purchase, Master Lease, Sublease and Escrow Agreement of 1201 Washington Boulevard in Stamford for Student Housing at UConn Stamford                     | 8 |
| 10) Purchase of 44 Lake Street, Coventry, CT  | 9 |

**CAPITAL PROJECT BUDGETS FOR APPROVAL:**

	<b><u>Phase</u></b>	<b><u>Budget</u></b>	<b><u>Tab</u></b>
11) Reflection Garden	Design	\$800,000	10
12) Hartford Café	Final	\$1,100,000	11
13) Northwest Residential Area Thermal Comfort Improvements	Final	\$6,750,000	12
14) Whitney Road Steam Improvements E-8 to Q-8	Final	\$8,500,000	13
15) Coventry Boathouse	Final	\$2,650,000	14
16) Homer Babbidge Library Stairs and Doors	Revised Final	\$1,004,300	15

**UCONN HEALTH**

17) Torrington Clinical Practice Relocation	Planning	\$4,800,000	16
18) Interventional Radiology Equipment Replacement & Renovation	Design	\$4,700,000	17
19) Hybrid OR #2 Fit-Out	Final	\$6,750,000	18
20) New England Sickle Cell Institute Renovation	Revised Final	\$5,800,000	19

**INFORMATION ITEMS:**

- 21) University Senate Representative Report
- 22) Contracts and Agreements for Information 20
- 23) Construction Project Status Report  
<https://bpir.media.uconn.edu/wp-content/uploads/sites/3452/2024/11/Construction-Status-Report-12.11.24.pdf>
- 24) Other Business
- 25) Executive Session (as needed)
- 26) Adjournment

PLEASE NOTE: *If you are an individual with a disability and require accommodations, please e-mail the Board of Trustees Office at [boardoftrustees@uconn.edu](mailto:boardoftrustees@uconn.edu) prior to the meeting.*

# ATTACHMENT 1

---

# MINUTES

## University of Connecticut Board of Trustees

### Financial Affairs Committee Special Virtual Meeting October 24, 2024

Committee Trustees:	Andy Bessette, Mark Boxer, Shari Cantor, Sean Dunn, Kevin O'Connor, Daniel O'Keefe, Philip Rubin
Other Trustees:	Daniel Toscano
University Senate Representatives to the Financial Affairs Committee	Lisa Park Boush, Michael White
University Staff:	Radenka Maric, Andrew Agwunobi, Laura Burton, Robert Corbett, Anne D'Alleva, Nathan Fuerst, Gail Garber, Jeffrey Geoghegan, Andrea Keilty, Michael Kirk, Nathan LaVallee, Joann Lombardo, Peggy McCarthy, Stanley Nolan, Rachel Rubin, Heather Ryan, Leslie Shor, Joseph Thompson, Michelle Williams, Kristen Wirtanen, Reka Wrynn

Vice-Chair Bessette called the meeting to order at 9:00 a.m.

1. Public Participation

No members of the public signed up to address the Committee.

2. Minutes of the Financial Affairs Committee Meeting of September 24, 2024

On a motion by Trustee Rubin, seconded by Trustee Boxer, the Committee voted unanimously to approve the minutes of the September 24, 2024, Meeting.

3. Contracts and Agreements for Approval

On a motion by Trustee O'Connor, seconded by Trustee Boxer, the Committee voted unanimously to recommend this item to the full Board for approval.

4. FY25 UConn and UConn Health Budget Update

Presenter: Jeffrey P. Geoghegan, Executive Vice President for Finance and Chief Financial Officer

5. Capital Project Budgets for Approval ~ Storrs Based Programs

On a motion by Trustee Cantor, seconded by Trustee Dunn, the Committee voted unanimously to approve the following project budgets:

Gampel Pavilion Renovation (Revised Final); Northwest Residential Area – Thermal Comfort Improvements (Design); School of Nursing Building (Final); Field House – Old Rec Center Renovation (Revised Final).

6. University Senate Representative Report

Lisa Park Boush provide a brief report of the University Senate.

7. Contracts and Agreements for Information

This agenda item was informational.

8. Construction Project Status Report

This agenda item was informational.

9. FY25 Capital Project Expenditure Report as of 09/30/24

This agenda item was informational.

10. Other Business

There was no Other Business.

11. Executive Session

There was no Executive Session.

12. Adjournment

On a motion by Trustee Cantor, seconded by Trustee Bessette, the Committee voted unanimously to adjourn the meeting. The Committee adjourned at 9:48 a.m.

Respectfully submitted,

*Debbie L. Carone*

Debbie L. Carone  
Secretary to the Committee

# ATTACHMENT 2

**UNIVERSITY OF CONNECTICUT**  
 The Administration is seeking approval to enter into contracts based on the material terms and conditions identified below.  
**CONTRACTS AND PURCHASE ORDERS OF \$1,000,000 OR MORE**  
**FOR UCONN BOARD OF TRUSTEES APPROVAL ON DECEMBER 11, 2024**

**\*\*S/MBE OR CT-Based Coding: S=Small, M=Minority, W=Woman Owned, C= CT-Based**

<b>NEW (Grouped by Family)</b>										
No.	Contractor	Approval Amount	Term	Description/Purpose	Fund Source	UConn Business Owner	Sourcing	Spend to Date (Actual)	S/MBE/WBE/CT Based	
<b>FACILITIES OPERATIONS</b>										
1	McPhee Electric Limited Contract #S073124	\$3,000,000	12/01/24-11/30/29	Contractor will provide High Voltage Maintenance and Repair Services on an as needed basis for UConn's Storrs campuses. This includes high voltage lines, equipment and electrical systems. This agreement has a term of five years with zero extensions.	Operating Funds	Stanley Nolan, Interim Associate Vice President Facilities Operations	Sole Source	\$0		
<b>TECHNOLOGY</b>										
2	Northeast Research & Educ Network (NEREN) Contract # TBD	\$2,000,000	01/01/25-12/31/28	NEREN is a consortium of non-profit organizations that provide a fiber-optic network connecting and unifying the research and education communities in New York and New England. NEREN securely enables universities in the world to explore the global resources that utilize ultra broadband applications. This contract covers membership fees and broadband applications and services for Connecticut Education Network (CEN). Initial term of this agreement is three years, with two possible extensions of one year each.	Operating Funds	Michael Mundrane Vice President and Chief Information Officer	GPO/Consortia	\$0		
<b>AMENDMENTS (Grouped by Family)</b>										
No.	Contractor	Approval Amount	Term	Description/Purpose	Fund Source	UConn Business Owner	Sourcing	Spend to Date (Actual)	S/MBE/WBE/CT Based	
<b>BUSINESS SUPPORT SERVICES</b>										
3	W.B. Mason Contract # 18PSX0032	\$500,000 (Previous Contract Value \$1,450,000; Total New Contract Value \$1,950,000)	01/01/19-12/31/24 (No Change)	Office supplies, toner and cut sheet paper for all University campuses. <b>Amend to increase contract value \$500,000 for a total new contract value of \$1,950,000.</b> Contract term remains the same. Sourced through a State of Connecticut agreement. Future extensions may be exercised at the discretion of the State.	Operating Funds	Joseph Thompson, Associate Vice President and Chief Procurement Officer	Other/State Bid	\$1,376,939		
<b>CONSTRUCTION</b>										
4	A/Z Corporation Contract #159-1-NV-022823	\$0 (Previous Contract Value \$3,000,000; Contract Value Remains the Same)	02/26/20-12/31/25 (includes an additional year, beginning 12/31/24)	On-Call Trade Contractor Services, Telecommunications Systems to be used at all UConn campuses to provide project support as needed. <b>Amend to extend contract term one year, through 12/31/25.</b> Contract value remains the same. Zero extensions remain.	Multiple Sources	Michael Mundrane, Vice President and Chief Information Officer	UConn Bid	\$1,661,640	C	
5	Fibre Optics Plus, Inc. Contract #159-3-NV-022823	\$0 (Previous Contract Value \$2,000,000; Contract Value Remains the Same)	02/24/20-12/31/25 (includes an additional year, beginning 12/31/24)	On-Call Trade Contractor Services, Telecommunications Systems to be used at all UConn campuses to provide project support as needed. <b>Amend to extend contract term one year, through 12/31/25.</b> Contract value remains the same. Zero extensions remain.	Multiple Sources	Michael Mundrane, Vice President and Chief Information Officer	UConn Bid	\$653,692	C, M	
6	Mercury Cabling Systems, LLC Contract #159-4-NV-022823	\$2,000,000 (Previous Contract Value \$0; Total New Contract Value \$2,000,000)	02/26/20-12/31/25 (includes an additional year, beginning 12/31/24)	On-Call Trade Contractor Services, Telecommunications Systems to be used at all UConn campuses to provide project support as needed. <b>Amend to change from "No Value" to "Value" contract and increase contract value by \$2,000,000 for a total new contract value of \$2,000,000.</b> Amend to extend contract term one year, through 12/31/25. Zero extensions remain.	Multiple Sources	Michael Mundrane, Vice President and Chief Information Officer	UConn Bid	\$699,354	C, S	
7	Northeastern Communications & Electrical, LLC Contract #159-5-NV-022823	\$2,000,000 (Previous Contract Value \$0; Total New Contract Value \$2,000,000)	02/26/20-12/31/25 (includes an additional year, beginning 12/31/24)	On-Call Trade Contractor Services, Telecommunications Systems to be used at all UConn campuses to provide project support as needed. <b>Amend to change from "No Value" to "Value" contract and increase contract value by \$2,000,000 for a total new contract value of \$2,000,000.</b> Amend to extend contract term one year, through 12/31/25. Zero extensions remain.	Multiple Sources	Michael Mundrane, Vice President and Chief Information Officer	UConn Bid	\$680,999	C, S, W	
8	SystemOne, LLC Contract #159-6-NV-022823	\$2,000,000 (Previous Contract Value \$0; Total New Contract Value \$2,000,000)	02/26/20-12/31/25 (includes an additional year, beginning 12/31/24)	On-Call Trade Contractor Services, Telecommunications Systems to be used at all UConn campuses to provide project support as needed. <b>Amend to change from "No Value" to "Value" contract and increase contract value by \$2,000,000 for a total new contract value of \$2,000,000.</b> Amend to extend contract term one year, through 12/31/25. Zero extensions remain.	Multiple Sources	Michael Mundrane, Vice President and Chief Information Officer	UConn Bid	\$312,002	C, S, W	
<b>FACILITIES OPERATIONS</b>										
9	John C. Diggert, Inc. Contract #S072922	\$1,200,000 (Previous Contract Value \$900,000; Total New Contract Value \$2,100,000)	07/01/23-06/30/25 (No Change)	Contractor provides inspection, maintenance, and repair services for above ground and underground tank systems, oil separators, and hydrodynamic (grit) stormwater separators. Services also include removal and replacement of underground storage tanks that have reached their life of expectancy. <b>Amend to increase contract value by \$1,200,000 for a total new contract value of \$2,100,000.</b> Contract term remains the same. Contract increase is requested to continue contracted services and to cover upcoming tank removal and replacement projects for five locations that are to be completed by the end of the contract term. Zero extensions remain.	Operating Funds	Stanley Nolan, Interim Associate Vice President Facilities Operations	UConn Bid	\$803,897		
10	Tucker Mechanical Inc. Contract #DS020119-11	\$1,500,000 (Previous Contract Value \$3,200,000; Total New Contract Value \$4,700,000)	07/01/19-06/30/27 (No Change)	University contract to provide service, maintenance and repairs to mechanical systems for all University locations. <b>Amend to increase contract value by \$1,500,000 for a total new contract value of \$4,700,000.</b> The requested increase is for continued and upcoming maintenance and repair services provided by contractor on University mechanical systems that are to be completed by the end of FY25. Zero extensions remain.	Operating Funds	Stanley Nolan, Interim Associate Vice President Facilities Operations	UConn Bid	\$2,659,672		
<b>PROFESSIONAL &amp; SPECIALIZED SERVICES</b>										
11	HRP Consulting Group, division of BRANY (Biomedical Research Alliance of NY) Contract # MF100220	\$0 (Previous Contract Value \$3,793,111; Contract Value Remains the Same)	03/19/21-03/18/26 (includes an additional 1 year extension, beginning on 03/18/25)	Consulting services and temporary staffing assistance for the OVPR's Sponsored Programs Services and Research Compliance units. <b>Amend to extend contract term one year, through 03/18/26.</b> Increase is requested to accommodate requirements for temporary staffing. Zero extensions remain.	Operating Funds	Julie Schwager, AVP, Office of the Vice President for Research	UConn Bid	\$2,775,102		

**UNIVERSITY OF CONNECTICUT**  
*The Administration is seeking approval to enter into contracts based on the material terms and conditions identified below.*  
**CONTRACTS AND PURCHASE ORDERS OF \$1,000,000 OR MORE**  
**FOR UCONN BOARD OF TRUSTEES APPROVAL ON DECEMBER 11, 2024**

**S/MBE OR CT-Based Coding: S=Small, M=Minority, W=Woman Owned, C= CT-Based										
NEW (Grouped by Family)										
No.	Contractor	Approval Amount	Term	Description/Purpose	Fund Source	UConn Business Owner	Sourcing	Spend to Date (Actual)	S/MBE/WBE/CT Based	
12	Robert Half International Inc. Contract # TS06-21	\$1,000,000 (Previous Contract Value \$5,200,000; Total New Contract Value \$6,200,000)	06/01/21-05/31/25 (No Change)	Temporary staffing, direct-hire, and other employer services used throughout University campuses. <b>Amend to increase contract value by \$1,000,000 for a total new contract value of \$6,200,000.</b> Contract term remains the same. Sourced through GPO/Consortia. Future extensions may be exercised at the discretion of the Consortia. Contract increase is requested to support ongoing temporary staffing needs across the University.	Multiple Sources	Joseph Thompson, Associate Vice President and Chief Procurement Officer	GPO/Consortia	\$3,444,351	..	
<b>TECHNOLOGY</b>										
13	DLT Solutions, LLC Contract # 180233-001	\$600,000 (Previous Contract Value \$1,400,000; Total New Contract Value \$2,000,000)	12/12/18-11/30/28 (includes an additional 3 years, beginning 11/30/25)	Purchase and maintenance of Oracle products, as well as additional cloud services for other operational platforms for all University campuses. This includes UConn Health and UConn Law. <b>Amend to increase contract value by \$600,000, for a total new contract value of \$2,000,000. Amend to extend contract term three (3) years, through 11/30/28.</b> Sourced through an OMNIA Partners consortium agreement. Future extensions may be exercised by OMNIA Partners. Contract increase is being requested to cover Oracle Primavera Unifier Portal User Cloud Service and annual maintenance for the next three years.	Multiple Sources	Michael Mundrane, Vice President and Chief Information Officer	GPO/Consortia	\$911,291		
14	Ex Libris (Usa) Inc Contract # AG71-090723	\$947,871 (Previous Contract Value \$552,129; Total New Contract Value \$1,500,000)	07/13/23-7/12/28 (includes an additional 3 years, beginning 7/13/25)	Ex Libris is integrated library platform management system used by the university library department. This includes for Alma, Alma Standard Sandbox, Primo VE, and Primo Standard Sandbox for the Library. <b>Amend to increase contract value by \$947,871, for total new contract value of \$1,500,000. Amend to extend contract term three (3) years, through 07/12/28.</b> Contract extension is requested to allow for renewal of services that are essential for the Library to function.	Operating Funds	Anne Langley, Dean, UConn Library	General Letter 71	\$547,129		
<b>REVENUE AMENDMENTS</b>										
<b>REVENUE AGREEMENTS</b>										
No.	Contractor	Approval Amount	Term	Description/Purpose	Fund Source	UConn Business Owner	Sourcing	Revenue to Date (Actual)	S/MBE/WBE/CT Based	
15	Connecticut Department of Social Services Contract # 15DSS2402AY	\$80,372 (Previous Contract Value \$62,225,156; Total New Contract Value \$62,305,528)	07/01/15-06/30/27 (No Change)	This revenue generating Memorandum of Agreement (MOA) is a partnership between the Connecticut Department of Social Services (DSS) and UConn School of Social Work whereby UConn will provide training, staff development, project/program development services, and vendor management support to DSS. <b>Amend to increase contract value by \$80,372, for total new contract value of \$62,305,528.</b> Extensions to this MOA may be exercised by written agreement of all parties.	Revenue Generating	Laura Curran, Dean of School of Social Work	Collaborative Grant (Pass-through)	\$62,225,156		
16	Connecticut Department of Education / American Rescue Plan Act of 2021 Contract # 21SDE0125AA	\$6,661,726 (Previous Contract Value \$3,591,078; Total New Contract Value \$10,252,804)	11/30/21-6/30/26 (No Change)	This revenue generating Memorandum of Agreement (MOA) is a partnership between the Connecticut Department of Education and the Center for Behavioral Education and Research in the Neag School of Education to continue implementation of the Connecticut K-3 Literacy Initiative (CK3LI). <b>Amend to increase contract value by \$6,661,726, for new contract value of \$10,252,804.</b> Contract term remains the same.	Revenue Generating	Michael Coyne, Principal Investigator	Collaborative Grant (Pass-through)	\$3,591,078		
17	Hill for Literacy 21SDE0125AA-2 Contract # SPS #220563	\$940,303 (Previous Contract Value \$4,999,999; Total New Contract Value \$5,940,302)	07/01/22-6/30/25 (No Change)	Hill for Literacy will work with The Center for Behavioral Education and Research (CBER) in the Neag School of Education at the University of Connecticut (UConn) to implement the CT K-3 Reading Model in Alliance Districts and support the work of the Center for Literacy Research and Reading Success. <b>Amend to increase contract value \$940,303, for total new contract value of \$5,940,302.</b> Contract term remains the same.	Revenue Generating	Michael Coyne, Principal Investigator	Collaborative Grant (Pass-through)	\$1,556,863		
<b>REAL ESTATE AGREEMENTS FOR APPROVAL *</b>										
<i>*Not all provisions of all Agreements appearing below have been 100% completed, but the Administration is seeking approval to proceed to execution based on the material terms described below.</i>										
<b>UNIVERSITY AS LESSOR - LEASE AGREEMENT</b>										
No.	Lessee	Annual Amount Payable	Term	Purpose	Fund Source	Program Director				
1	Bear's Smokehouse, LLC	\$33,150 in base rent annually plus 12% of gross monthly sales up to \$1 million annually, and thereafter 4.5% of gross monthly sales above \$1 million annually.	5 years w/two 5-year renewal options.	Clarification on lease terms for the Bear's Barbecue space at the Student Union on the Storrs campus changing the rent percentage over \$1 million in gross sales.	Not Applicable	Isaac Barber, Director, Student Union and Event Services.				
<b>UNIVERSITY AS LESSEE - LEASE AGREEMENT</b>										
No.	Lessor	Annual Amount Payable	Term	Purpose	Fund Source	Program Director				
2	EdR Storrs, LLC (DBA The Oaks on the Square)	\$14,300,000 in Year 1 and \$14,800,000 in Year 2.	2 years	An amendment to the current Reservation Agreement to lease a total of 381 units for the '25-'26 and '26-'27 school years. UConn will sublease the units for approximately 760 students to support enrollment growth.	Operating Funds	Nathan Fuerst, Vice President of Student Life and Enrollment				
3	Green Hub Development III, LLC	Not Applicable	Not Applicable	A lease amendment to reconcile the square footage and floors to be occupied within the building to the actual constructed square footage. The total square increased from 26,300 to 27,007 square feet (707 sf difference). The annual rent remains unchanged.	Not Applicable	Fumiko Hoef, Campus Dean and Chief Administrative Officer, Waterbury Campus				
4	Orefice, Charles	\$25,200	04/21/25 -04/30/26	Lease of a 1,266 sf apartment located at 190 South Thames Street, Unit #20, Norwich, CT. This apartment accommodates up to two medical students at a time while they are completing their 6-week clinical rotations at Backus Hospital.	Operating Funds	Melissa Held, Senior Assoc Dean-MSE, Academic Affairs and Education				
5	One Torrington Office Plaza, LLC	\$197,414	10 year term plus two 5-year renewal options	Lease of 10,671 sf of the building located at 507 East Main St in Torrington. The initial term is 10 years with the option to extend for two additional 5-year periods. This space will be used for UMG medical practices.	Operating Funds	Anne Horbatuck, VP/COO, Ambulatory Svcs, UMG Administration				



# ATTACHMENT 3

---

# FY25 Budget Update

UConn State Support (\$M)	Approved	Reduction
Permanent / Block Grant	\$227.5	(\$2.4)
Additional One-Time	98.8	(4.3)
<b>Total</b>	<b>\$326.2</b>	<b>(\$6.7)</b>

UConn Health State Support (\$M)	Approved	Reduction
Permanent / Block Grant	\$118.2	(\$1.4)
Additional One-Time	75.5	(4.3)
<b>Total</b>	<b>\$193.7</b>	<b>(\$5.7)</b>

# ATTACHMENT 4

---



December 11, 2024

TO: Members of the Board of Trustees

FROM: Jeffrey P. Geoghegan, CPA   
Executive Vice President for Finance & Chief Financial Officer

Anne D'Alleva   
Provost and Executive Vice President for Academic Affairs

RE: Academic Year 2025/26 Student Fees for the University of Connecticut, Storrs, and Regional Campuses

RECOMMENDATION:

The Board of Trustees approves increases to select Student Mandatory Fees, Housing Rates, Dining Rates, and Academic Program Fees for Academic Year 25/26, as detailed in the attachments.

RESOLUTION:

“Be it resolved that the University’s Student Fees for Academic Year 25/26 shall be set according to the attached Rate Schedule.”

BACKGROUND:

Institutional Fees

Institutional Fees require central administrative approval and include fees such as Housing and Dining, select mandatory fees (e.g., Infrastructure Maintenance Fee, Transit Fee, etc.), and other specific fees such as late fees, escrow fees, etc.

Housing and Dining:

A rate increase of 2.75% will lead to an additional cost of \$108 per semester or \$216 for the academic year for Housing (Double - lowest cost option) rates on the Storrs campus. The Dining (Value Plan) rate will increase by \$90 per semester or \$180 per academic year. Other housing rates on the Storrs campus will increase from 2.75% to 12%. In Stamford, all rates will increase by 2.75%.

These adjustments to Housing and Dining rates are driven by rising costs for maintaining existing programs and investing in new ones, competition from off-campus housing, and student demand. In addition, select housing rates need to be reset to be reflective of the

improvements made and amenities provided. A full rate schedule, including all housing and dining options, is included.

Infrastructure Maintenance Fee: An increase of \$35 per semester or \$70 per academic year across all campuses. The fee directly supports many University facilities' maintenance costs and payments toward select debt-financed infrastructure improvements. Additional revenues will go towards continued facility and infrastructure improvements while supporting sustainability efforts.

Technology Fee: An increase of \$10 per semester or \$20 per academic year across all campuses. The fee supports various IT services for all students, such as enterprise-wide software products for educational and personal use, over 330 high-tech classrooms and computer lab equipment, wireless capacity in student-centric areas, and media-related library services.

Transit Fee: An increase of \$9 per semester or \$18 per academic year to the Storrs rate. Although the rate has increased in prior years, those revenues have directly funded the State's UPass program. These new revenues will offset rising costs in the University's transit program. The regional campus rate will increase by \$2 per semester or \$4 per academic year.

## Student Fees

Student Fees, including those of students, faculty, and administrative representatives, are reviewed and proposed through the Student Activity and Service Fee Advisory Committee (SASFAC). Increases are requested for the General University Fee, Student Health and Wellness Fee, and Student Activity/Student Government Fees.

General University Fee (GUF): An increase of \$49 per semester or \$98 per academic year to the Storrs rate and \$4 per semester or \$8 per academic year to the regional rate. The fee supports student-related programs. These programs are, by definition, supplementary to the University's educational mission and must generate operating revenue through fees or use charges.

Student Health and Wellness (SHaW) Fee: An increase of \$40 per semester or \$80 per academic year to the Storrs rate and \$4 per semester or \$8 per academic year to the regional rate. New revenues will help fund prior year contractual salary increases. The program continues to be subsidized.

Student Activity/Government Fee: An increase up to \$3 per semester or \$6 per academic year to the Storrs rate and \$1 per semester or \$2 per academic year to the regional campus and graduate rate. The rate reflected is the maximum allowable increase. The individual student programs propose Student Activity Fees, with any increase recommended to leadership through the Student Activity and Service Fee Advisory Committee (SASFAC). These fees are not part of the university's operating budget; all revenues go directly to the respective student organizations.

## Other Fees

Visa Compliance Fee: An increase of \$100 per semester or \$200 per academic year. This fee is charged on a semester basis to F or J visa-sponsored students. Revenues from this fee provide students with visa compliance advising, support and programming for international students, and the expansion of services. The visa compliance fee has stayed the same since its inception in 2017.

## Academic Program Fees

Academic Program fees include specific program or course fees. A committee led by the Provost's Office reviews and proposes them to senior leadership. Academic Program fees apply to all students within a specific program.

### School of Business

Recommendation: To approve a fee increase from \$1,150/credit to \$1,200/credit.

- MS Human Resources Management
- Advanced Business Certificate in Health Care Analytics
- Advanced Business Certificate in Health Care Finance and Insurance
- Advanced Business Certificate in Human Resources Management
- Advanced Business Certificate in Information Technology Audit
- Advanced Business Certificate in Digital Marketing Strategy
- Certificate in Corporate and Regulatory Compliance
- Certificate in Global Risk Management
- Long-term Health Care Management Certificate
- Part-time MBA
- Online MBA, MBA

Recommendation: To approve a fee increase from \$1,075/credit to \$1,125/credit.

- MS in Accounting
- Accounting Fundamentals Certificate
- Advanced Business Certificate in Accounting Analytics

**UNIVERSITY OF CONNECTICUT**  
**Undergraduate Schedule of Full-time Tuition and Common Fees**

	FY25			FY26 Proposed		
	<u>Resident</u>	<u>Non-Resident</u>	<u>NE Regional</u>	<u>Resident</u>	<u>Non-Resident</u>	<u>NE Regional</u>
<b>STORRS</b>						
Tuition	\$ 17,010	\$ 39,678	\$ 26,028	\$ 17,010	\$ 39,678	\$ 26,028
General University Fee	1,570	1,570	1,570	1,668	1,668	1,668
Student Health Services	776	776	776	856	856	856
Student Recreation Center Fee	500	500	500	500	500	500
Infrastructure Maintenance Fee	618	618	618	688	688	688
Student Activity Fee	192	192	192	198	198	198
Technology Fee	184	184	184	204	204	204
Transit Fee	194	194	194	212	212	212
Total, Commuting Student	\$ 21,044	\$ 43,712	\$ 30,062	\$ 21,336	\$ 44,004	\$ 30,354
Room Fee (Double)	7,850	7,850	7,850	8,066	8,066	8,066
Board Fee (Value)	6,530	6,530	6,531	6,710	6,710	6,710
Total, Dormitory Student	\$ 35,424	\$ 58,092	\$ 44,443	\$ 36,112	\$ 58,780	\$ 45,130
<b>EVERETT</b>						
Tuition	\$ 17,010	\$ 39,678	\$ 26,028	\$ 17,010	\$ 39,678	\$ 26,028
General University Fee	124	124	124	132	132	132
Student Health Services	80	80	80	88	88	88
Infrastructure Maintenance Fee	618	618	618	688	688	688
Student Government	70	70	70	72	72	72
Transit Fee	54	54	54	58	58	58
Technology Fee	184	184	184	204	204	204
Total	\$ 18,140	\$ 40,808	\$ 27,158	\$ 18,252	\$ 40,920	\$ 27,270
<b>HARTFORD</b>						
Tuition	\$ 17,010	\$ 39,678	\$ 26,028	\$ 17,010	\$ 39,678	\$ 26,028
General University Fee	124	124	124	132	132	132
Student Health Services	80	80	80	88	88	88
Infrastructure Maintenance Fee	618	618	618	688	688	688
Student Government	60	60	60	62	62	62
Transit Fee	54	54	54	58	58	58
Technology Fee	184	184	184	204	204	204
Total	\$ 18,130	\$ 40,798	\$ 27,148	\$ 18,242	\$ 40,910	\$ 27,260

**UNIVERSITY OF CONNECTICUT**  
**Undergraduate Schedule of Full-time Tuition and Common Fees**

	FY25			FY26 Proposed		
	<u>Resident</u>	<u>Non-Resident</u>	<u>NE Regional</u>	<u>Resident</u>	<u>Non-Resident</u>	<u>NE Regional</u>
<b>STAMFORD</b>						
Tuition	\$ 17,010	\$ 39,678	\$ 26,028	\$ 17,010	\$ 39,678	\$ 26,028
General University Fee	124	124	124	132	132	132
Student Health Services	80	80	80	88	88	88
Infrastructure Maintenance Fee	618	618	618	688	688	688
Student Government	80	80	80	82	82	82
Transit Fee	54	54	54	58	58	58
Technology Fee	184	184	184	204	204	204
Total, Commuting Student	18,150	40,818	27,168	18,262	\$ 40,930	27,280
Room Fee (Stamford Rate 1)	11,698	11,698	11,698	12,020	12,020	12,020
Total, Dormitory Student	\$ 29,848	\$ 52,516	\$ 38,866	\$ 30,282	\$ 52,950	\$ 39,300
<b>WATERBURY</b>						
Tuition	\$ 17,010	\$ 39,678	\$ 26,028	\$ 17,010	\$ 39,678	\$ 26,028
General University Fee	124	124	124	132	132	132
Student Health Services	80	80	80	88	88	88
Infrastructure Maintenance Fee	618	618	618	688	688	688
Student Government	70	70	70	72	72	72
Transit Fee	54	54	54	58	58	58
Technology Fee	184	184	184	204	204	204
Total	\$ 18,140	\$ 40,808	\$ 27,158	\$ 18,252	\$ 40,920	\$ 27,270
<b>PHARMACY (Pharm. D.)</b>						
Tuition	\$ 29,842	\$ 58,014	\$ 48,480	\$ 29,842	\$ 58,014	\$ 48,480
General University Fee	1,570	1,570	1,570	1,668	1,668	1,668
Student Health Services	776	776	776	856	856	856
Student Recreation Center Fee	500	500	500	500	500	500
Infrastructure Maintenance Fee	618	618	618	688	688	688
Technology Fee	184	184	184	204	204	204
Student Activity Fee	192	192	192	198	198	198
Transit Fee	194	194	194	212	212	212
Total, Commuting Student	\$ 33,876	\$ 62,048	\$ 52,514	\$ 34,168	\$ 62,340	\$ 52,806
Room Fee (Double)	7,850	7,850	7,850	8,066	8,066	8,066
Board Fee (Value)	6,530	6,530	6,531	6,710	6,710	6,710
Total, Dormitory Student	\$ 48,256	\$ 76,428	\$ 66,895	\$ 48,944	\$ 77,116	\$ 67,582



**UNIVERSITY OF CONNECTICUT**  
**Graduate Schedule of Full-time Tuition and Common Fees**

	FY25			FY26 Proposed		
	<u>Resident</u>	<u>Non-Resident</u>	<u>NE Regional</u>	<u>Resident</u>	<u>Non-Resident</u>	<u>NE Regional</u>
<b>STORRS</b>						
Tuition	\$ 19,512	\$ 41,424	\$ 30,408	\$ 19,512	\$ 41,424	\$ 30,408
General University Fee	1,072	1,072	1,072	1,170	1,170	1,170
Student Health Services	776	776	776	856	856	856
Student Recreation Center Fee	400	400	400	400	400	400
Infrastructure Maintenance Fee	618	618	618	688	688	688
Student Activity Fee	32	32	32	34	34	34
Graduate Matriculation Fee	84	84	84	84	84	84
Transit Fee	194	194	194	212	212	212
Technology Fee	184	184	184	204	204	204
Total, Commuting Student	\$ 22,872	\$ 44,784	\$ 33,768	\$ 23,160	\$ 45,072	\$ 34,056
Room Fee (Rate 4)	9,830	9,830	9,830	10,616	10,616	10,616
Board Fee (Value)	6,530	6,530	6,530	6,710	6,710	6,530
Total, Dormitory Student	\$ 39,232	\$ 61,144	\$ 50,128	\$ 40,487	\$ 62,399	\$ 51,202
<b>STORRS-DPT (PHYSICAL THERAPY)</b>						
Tuition	\$ 24,970	\$ 46,900	\$ 35,854	\$ 24,970	\$ 46,900	\$ 35,854
General University Fee	1,072	1,072	1,072	1,170	1,170	1,170
Student Health Services	776	776	776	856	856	856
Student Recreation Center Fee	400	400	400	400	400	400
Infrastructure Maintenance Fee	618	618	618	688	688	688
Student Activity Fee	32	32	32	34	34	34
Graduate Matriculation Fee	84	84	84	84	84	84
Transit Fee	194	194	194	212	212	212
Technology Fee	184	184	184	204	204	204
Total, Commuting Student	\$ 28,330	\$ 50,260	\$ 39,214	\$ 28,618	\$ 50,548	\$ 39,502
Room Fee (Rate 4)	9,830	9,830	9,830	10,616	10,616	10,616
Board Fee (Value)	6,530	6,530	6,530	6,710	6,710	6,530
Total, Dormitory Student	\$ 44,690	\$ 66,620	\$ 55,574	\$ 45,945	\$ 67,875	\$ 56,648
<b>LAW SCHOOL-Day</b>						
Tuition	\$ 30,354	\$ 61,396	\$ 51,786	\$ 30,354	\$ 61,396	\$ 51,786
General University Fee	124	124	124	132	132	132
Infrastructure Maintenance Fee	618	618	618	688	688	688
Student Activity Fee*	164	164	164	166	166	166
Transit Fee	64	64	64	58	58	58
Technology Fee	184	184	184	204	204	204
Total	\$ 31,508	\$ 62,550	\$ 52,940	\$ 31,602	\$ 62,644	\$ 53,034
<b>SOCIAL WORK</b>						
Tuition	\$ 19,512	\$ 41,424	\$ 30,408	\$ 19,512	\$ 41,424	\$ 30,408
General University Fee	124	124	124	132	132	132
Infrastructure Maintenance Fee	618	618	618	688	688	688
Graduate Matriculation Fee	84	84	84	84	84	84
Student Activity Fee*	50	50	50	52	52	52
Transit Fee	64	64	64	58	58	58
Technology Fee	184	184	184	204	204	204
Total	\$ 20,636	\$ 42,548	\$ 31,532	\$ 20,730	\$ 42,642	\$ 31,626

**UNIVERSITY OF CONNECTICUT**  
**Graduate Schedule of Full-time Tuition and Common Fees**

	FY25			FY26 Proposed		
<b>STAMFORD Ph. D.</b>						
Tuition	\$ 23,012	\$ 41,424	\$ 36,530	\$ 23,012	\$ 41,424	\$ 36,530
General University Fee	124	124	124	132	132	132
Infrastructure Maintenance Fee	618	618	618	688	688	688
Graduate Matriculation Fee	84	84	84	84	84	84
Transit Fee	64	64	64	58	58	58
Technology Fee	184	184	184	204	204	204
Total	\$ 24,086	\$ 42,498	\$ 37,604	\$ 24,178	\$ 42,590	\$ 37,696
<b>LAW SCHOOL-Evening</b>						
Tuition	\$ 22,160	\$ 44,180	\$ 37,440	\$ 22,160	\$ 44,180	\$ 37,440
General University Fee	124	124	124	132	132	132
Infrastructure Maintenance Fee	618	618	618	688	688	688
Student Activity Fee*	164	164	164	166	166	166
Transit Fee	64	64	64	58	58	58
Technology Fee	184	184	184	204	204	204
Total	\$ 23,314	\$ 45,334	\$ 38,594	\$ 23,408	\$ 45,428	\$ 38,688
<b>LAW SCHOOL-SJD</b>						
Tuition	\$ 10,538	\$ 18,902	\$ 17,108	\$ 10,538	\$ 18,902	\$ 17,108
General University Fee	124	124	124	132	132	132
Infrastructure Maintenance Fee	618	618	618	688	688	688
Student Activity Fee*	164	164	164	166	166	166
Transit Fee	64	64	64	58	58	58
Technology Fee	184	184	184	204	204	204
Total	\$ 11,692	\$ 20,056	\$ 18,262	\$ 11,786	\$ 20,150	\$ 18,356

\*Student Activity Fee increase by \$2, capped amount increase.

**UNIVERSITY OF CONNECTICUT**  
Tuition Rates Per Credit

Credits	Undergraduate			Graduate / Social Work			Law - Day Division			Law - Evening Division		
	Resident	Non-Resid	NE Reg	Resident	Non-Resid	NE Reg	Resident	Non-Resid	NE Reg	Resident	Non-Resid	NE Reg
<b><u>2024-25</u></b>												
1	709	1,654	1,085	1,084	2,302	1,690	1,265	2,559	2,158	1,059	2,142	1,807
2	1,418	3,308	2,170	2,168	4,604	3,380	2,530	5,118	4,316	2,118	4,284	3,614
3	2,127	4,962	3,255	3,252	6,906	5,070	3,795	7,677	6,474	3,177	6,426	5,421
4	2,836	6,616	4,340	4,336	9,208	6,760	5,060	10,236	8,632	4,236	8,568	7,228
5	3,545	8,270	5,425	5,420	11,510	8,450	6,325	12,795	10,790	5,295	10,710	9,035
6	4,254	9,924	6,510	6,504	13,812	10,140	7,590	15,354	12,948	6,354	12,852	10,842
7	4,963	11,578	7,595	7,588	16,114	11,830	8,855	17,913	15,106	7,413	14,994	12,649
8	5,672	13,232	8,680	8,672	18,416	13,520	10,120	20,472	17,264	8,472	17,136	14,456
9	6,381	14,886	9,765	9,756	20,712	15,204	11,385	23,031	19,422	9,531	19,278	16,263
10	7,090	16,540	10,850				12,650	25,590	21,580	10,590	21,420	18,070
11	7,799	18,194	11,935				13,915	28,149	23,738			
12	8,505	19,839	13,014				15,177	30,698	25,893			
annual - full time	17,010	39,678	26,028	19,512	41,424	30,408	30,354	61,396	51,786	21,180	42,840	36,140
<b><u>2025-26</u></b>												
1	709	1,654	1,085	1,084	2,302	1,690	1,265	2,559	2,158	1,059	2,142	1,807
2	1,418	3,308	2,170	2,168	4,604	3,380	2,530	5,118	4,316	2,118	4,284	3,614
3	2,127	4,962	3,255	3,252	6,906	5,070	3,795	7,677	6,474	3,177	6,426	5,421
4	2,836	6,616	4,340	4,336	9,208	6,760	5,060	10,236	8,632	4,236	8,568	7,228
5	3,545	8,270	5,425	5,420	11,510	8,450	6,325	12,795	10,790	5,295	10,710	9,035
6	4,254	9,924	6,510	6,504	13,812	10,140	7,590	15,354	12,948	6,354	12,852	10,842
7	4,963	11,578	7,595	7,588	16,114	11,830	8,855	17,913	15,106	7,413	14,994	12,649
8	5,672	13,232	8,680	8,672	18,416	13,520	10,120	20,472	17,264	8,472	17,136	14,456
9	6,381	14,886	9,765	9,756	20,712	15,204	11,385	23,031	19,422	9,531	19,278	16,263
10	7,090	16,540	10,850				12,650	25,590	21,580	10,590	21,420	18,070
11	7,799	18,194	11,935				13,915	28,149	23,738			
12	8,505	19,839	13,014				15,177	30,698	25,893			
annual - full time	17,010	39,678	26,028	19,512	41,424	30,408	30,354	61,396	51,786	21,180	42,840	36,140

**UNIVERSITY OF CONNECTICUT  
Tuition Rates Per Credit**

Credits	Stamford Ph.D			Pharmacy (Pharm.D.)			Physical Therapy (DPT)			SJD Law		
	Resident	Non-Resid	NE Reg	Resident	Non-Resid	NE Reg	Resident	Non-Resid	NE Reg	Resident	Non-Resid	NE Reg
<b><u>2024-25</u></b>												
1	1,279	2,302	2,030	1,658	3,223	2,694	1,388	2,606	1,992	586	1,051	951
2	2,558	4,604	4,060	3,316	6,446	5,388	2,776	5,212	3,984	1,172	2,102	1,902
3	3,837	6,906	6,090	4,974	9,669	8,082	4,164	7,818	5,976	1,758	3,153	2,853
4	5,116	9,208	8,120	6,632	12,892	10,776	5,552	10,424	7,968	2,344	4,204	3,804
5	6,395	11,510	10,150	8,290	16,115	13,470	6,940	13,030	9,960	2,930	5,255	4,755
6	7,674	13,812	12,180	9,948	19,338	16,164	8,328	15,636	11,952	3,516	6,306	5,706
7	8,953	16,114	14,210	11,606	22,561	18,858	9,716	18,242	13,944	4,102	7,357	6,657
8	10,232	18,416	16,240	13,264	25,784	21,552	11,104	20,848	15,936	4,688	8,408	7,608
9	11,506	20,712	18,265	14,921	29,007	24,240	12,485	23,450	17,927	5,269	9,451	8,554
10												
11												
12												
annual - full time	23,012	41,424	36,530	29,842	58,014	48,480	24,970	46,900	35,854	10,538	18,902	17,108
<b><u>2025-26</u></b>												
1	1,279	2,302	2,030	1,658	3,223	2,694	1,388	2,606	1,992	586	1,051	951
2	2,558	4,604	4,060	3,316	6,446	5,388	2,776	5,212	3,984	1,172	2,102	1,902
3	3,837	6,906	6,090	4,974	9,669	8,082	4,164	7,818	5,976	1,758	3,153	2,853
4	5,116	9,208	8,120	6,632	12,892	10,776	5,552	10,424	7,968	2,344	4,204	3,804
5	6,395	11,510	10,150	8,290	16,115	13,470	6,940	13,030	9,960	2,930	5,255	4,755
6	7,674	13,812	12,180	9,948	19,338	16,164	8,328	15,636	11,952	3,516	6,306	5,706
7	8,953	16,114	14,210	11,606	22,561	18,858	9,716	18,242	13,944	4,102	7,357	6,657
8	10,232	18,416	16,240	13,264	25,784	21,552	11,104	20,848	15,936	4,688	8,408	7,608
9	11,506	20,712	18,265	14,921	29,007	24,240	12,485	23,450	17,927	5,269	9,451	8,554
10												
11												
12												
annual - full time	23,012	41,424	36,530	29,842	58,014	48,480	24,970	46,900	35,854	10,538	18,902	17,108

**UNIVERSITY OF CONNECTICUT  
Fee Charges**

Per Semester															
Infrastructure Maintenance Fee		General University Fee					Student Rec Center Fee (Storrs Only)		Student Health Services			Technology Fee			
Credits	Undergrad	Grad	Storrs		Off-Campus	Other Reg	Undergrad	Grad	(UG Storrs)	(UG	Student Health Services (Grad Storrs)	Undergrad	Grad	Summer / Intersession /Non-degree	
			Undergrad	Storrs Grad (c)	Grad (a)	Campus (a)				Regional)					
<b>2024-25</b>															
1	155	155	393	268	62	62	250	200	194	40	194	92	92	30	
2	155	155	393	268	62	62	250	200	194	40	194	92	92	30	
3	155	155	393	268	62	62	250	200	194	40	194	92	92	30	
4	155	155	393	268	62	62	250	200	194	40	194	92	92	30	
5	309	309	785	536	62	62	250	200	388	40	388	92	92	30	
6	309	309	785	536	62	62	250	200	388	40	388	92	92	30	
7	309	309	785	536	62	62	250	200	388	40	388	92	92	30	
8	309	309	785	536	62	62	250	200	388	40	388	92	92	30	
9	309	309	785	536	62	62	250	200	388	40	388	92	92	30	
10	309	309	785	536	62	62	250	200	388	40	388	92	92	30	
11	309	309	785	536	62	62	250	200	388	40	388	92	92	30	
12	309	309	785	536	62	62	250	200	388	40	388	92	92	30	
13	309	309	785	536	62	62	250	200	388	40	388	92	92	30	
<b>2025-26</b>															
1	172	172	417	293	66	66	250	200	214	44	214	102	102	30	
2	172	172	417	293	66	66	250	200	214	44	214	102	102	30	
3	172	172	417	293	66	66	250	200	214	44	214	102	102	30	
4	172	172	417	293	66	66	250	200	214	44	214	102	102	30	
5	344	344	834	585	66	66	250	200	428	44	428	102	102	30	
6	344	344	834	585	66	66	250	200	428	44	428	102	102	30	
7	344	344	834	585	66	66	250	200	428	44	428	102	102	30	
8	344	344	834	585	66	66	250	200	428	44	428	102	102	30	
9	344	344	834	585	66	66	250	200	428	44	428	102	102	30	
10	344	344	834	585	66	66	250	200	428	44	428	102	102	30	
11	344	344	834	585	66	66	250	200	428	44	428	102	102	30	
12	344	344	834	585	66	66	250	200	428	44	428	102	102	30	
13	344	344	834	585	66	66	250	200	428	44	428	102	102	30	

(a) The General University Fees for SSW, MPA HFTD, Law Day/Eve, Full Time MBA as well as for the other regional campuses are not prorated per credit.

(b) Law School summer and winter charges per credit are based on the evening division tuition plus prorated General University Fee.

(c) Executive MBA program at \$90,000 AY26

Undergraduate and Graduate students taking four or fewer credits pay 50% of the associated campus rate for the General University Fee, Student Health and Wellness Fee, and Infrastructure Maintenance Fee.

Non-Degree students pay the regional campus rate for mandatory fees

**UNIVERSITY OF CONNECTICUT  
Fee Charges By Credit**

Per Credit		
Online Fee	Storrs Non-Degree Fall/Spring	Summer, Intersession and Winter Session

Credits	Grad and Non-degree, & all students in intersessions and summer sessions	Undergrad Non-Degree and BGS, BPS	Grad	Undergrad	Grad
<b>2024-25</b>					
1	25	709	1,084	709	1,084
2	25	1,418	2,168	1,418	2,168
3	25	2,127	3,252	2,127	3,252
4	25	2,836	4,336	2,836	4,336
5	25	3,545	5,420	3,545	5,420
6	25	4,254	6,504	4,254	6,504
7	25	4,963	7,588	4,963	7,588
8	25	5,672	8,672	5,672	8,672
9	25	6,381	9,756	6,381	9,756
10	25	7,090		7,090	10,840
11	25	7,799		7,799	11,924
12	25	8,505		8,505	13,008
13	25			9,217	14,092

"Pop-Up" Courses are offered to matriculated students during summer session at no-cost

<b>2025.26</b>					
1	25	709	1,084	709	1,084
2	25	1,418	2,168	1,418	2,168
3	25	2,127	3,252	2,127	3,252
4	25	2,836	4,336	2,836	4,336
5	25	3,545	5,420	3,545	5,420
6	25	4,254	6,504	4,254	6,504
7	25	4,963	7,588	4,963	7,588
8	25	5,672	8,672	5,672	8,672
9	25	6,381	9,756	6,381	9,756
10	25	7,090		7,090	10,840
11	25	7,799		7,799	11,924
12	25	8,505		8,505	13,008
13	25			9,217	14,092

**UNIVERSITY OF CONNECTICUT  
Program Fee Charges By Credit**

Credits	Master of Engineering	Master in Data Science	Nursing - Doctorate in Nursing (PM/DNP)	Nursing - Practitioner (AGPCNP/AG ACNP/FNP/NP)	Nursing - Certificate (NPE,HN,PM, HI,DC,LSPR)	Nursing - Certificate Entry in Nursing BS (CEIN_BS)	Social Work Extension	Social Work MS Online	Neag - UCAPP	Survey Research, MPA Fellows, Nonprofit Management and Leadership & Public Management	Online Graduate Certificates and Programs, GIS and Post Secondary Disability Cert
<b>2024-25</b>											
1	1,300	1,325	1,200	1,200	925	867	1,084	880	970	1,000	925
2	2,600	2,650	2,400	2,400	1,850	1,734	2,168	1,760	1,940	2,000	1,850
3	3,900	3,975	3,600	3,600	2,775	2,601	3,252	2,640	2,910	3,000	2,775
4	5,200	5,300	4,800	4,800	3,700	3,468	4,336	3,520	3,880	4,000	3,700
5	6,500	6,625	6,000	6,000	4,625	4,335	5,420	4,400	4,850	5,000	4,625
6	7,800	7,950	7,200	7,200	5,550	5,202	6,504	5,280	5,820	6,000	5,550
7	9,100	9,275	8,400	8,400	6,475	6,069	7,588	6,160	6,790	7,000	6,475
8	10,400	10,600	9,600	9,600	7,400	6,936	8,672	7,040	7,760	8,000	7,400
9	11,700	11,925	10,800	10,800	8,325	7,803	9,756	7,920	8,730	9,000	8,325
10	13,000	13,250	12,000	12,000	9,250	8,670	10,840	8,800	9,700	10,000	9,250
11	14,300	14,575	13,200	13,200	10,175	9,537	11,924	9,680	10,670	11,000	10,175
12	15,600	15,900	14,400	14,400	11,100	10,404	13,008	10,560	11,640	12,000	11,100
13	16,900	17,225	15,600	15,600	12,025	11,271	14,092	11,440	12,610	13,000	12,025
<b>2025-26</b>											
1	1,300	1,325	1,200	1,200	925	867	1,084	880	970	1,000	925
2	2,600	2,650	2,400	2,400	1,850	1,734	2,168	1,760	1,940	2,000	1,850
3	3,900	3,975	3,600	3,600	2,775	2,601	3,252	2,640	2,910	3,000	2,775
4	5,200	5,300	4,800	4,800	3,700	3,468	4,336	3,520	3,880	4,000	3,700
5	6,500	6,625	6,000	6,000	4,625	4,335	5,420	4,400	4,850	5,000	4,625
6	7,800	7,950	7,200	7,200	5,550	5,202	6,504	5,280	5,820	6,000	5,550
7	9,100	9,275	8,400	8,400	6,475	6,069	7,588	6,160	6,790	7,000	6,475
8	10,400	10,600	9,600	9,600	7,400	6,936	8,672	7,040	7,760	8,000	7,400
9	11,700	11,925	10,800	10,800	8,325	7,803	9,756	7,920	8,730	9,000	8,325
10	13,000	13,250	12,000	12,000	9,250	8,670	10,840	8,800	9,700	10,000	9,250
11	14,300	14,575	13,200	13,200	10,175	9,537	11,924	9,680	10,670	11,000	10,175
12	15,600	15,900	14,400	14,400	11,100	10,404	13,008	10,560	11,640	12,000	11,100
13	16,900	17,225	15,600	15,600	12,025	11,271	14,092	11,440	12,610	13,000	12,025

**UNIVERSITY OF CONNECTICUT  
Program Fee Charges By Credit**

Credits	Business MSFRM / FINTECH per credit	Business (PTMBA) / (MSHRM) per credit	Business MSBAPM, ABCBA and ABCPM per credit	Business MSA per credit	Business Accounting Certificate Program (ACP)	Business Fee-Based Programs (Other) Non ACP- Per Credit	Music Performer's Certificate	LL.M. INSURANCE LAW	LL.M. U.S. Legal LAW, Executive LLM, LLM-Energy & Environmental Law & LLM-Human Rights & Social Justice, LLM in Governance, Risk Management and Compliance
<b>2024-25</b>									
1	1,500	1,150	1,200	1,075	1,075	1,150	925	1,326	1,326
2	3,000	2,300	2,400	2,150	2,150	2,300	1,850	2,652	2,652
3	4,500	3,450	3,600	3,225	3,225	3,450	2,775	3,978	3,978
4	6,000	4,600	4,800	4,300	4,300	4,600	3,700	5,304	5,304
5	7,500	5,750	6,000	5,375	5,375	5,750	4,625	6,630	6,630
6	9,000	6,900	7,200	6,450	6,450	6,900	5,550	7,956	7,956
7	10,500	8,050	8,400	7,525	7,525	8,050	6,475	9,282	9,282
8	12,000	9,200	9,600	8,600	8,600	9,200	7,400	10,608	10,608
9	13,500	10,350	10,800	9,675	9,675	10,350	8,325	11,934	11,934
10	15,000	11,500	12,000	10,750	10,750	11,500	9,250	13,260	13,260
11	16,500	12,650	13,200	11,825	11,825	12,650	10,175	14,586	14,586
12	18,000	13,800	14,400	12,900	12,900	13,800	11,100	15,912	15,912
13	19,500	14,950	15,600	13,975	13,975	14,950	12,025	17,238	17,238

Note: The University also offers an Executive MBA program at \$90,000

<b>2025-26</b>									
1	1,500	1,200	1,200	1,125	1,125	1,200	925	1,326	1,326
2	3,000	2,400	2,400	2,250	2,250	2,400	1,850	2,652	2,652
3	4,500	3,600	3,600	3,375	3,375	3,600	2,775	3,978	3,978
4	6,000	4,800	4,800	4,500	4,500	4,800	3,700	5,304	5,304
5	7,500	6,000	6,000	5,625	5,625	6,000	4,625	6,630	6,630
6	9,000	7,200	7,200	6,750	6,750	7,200	5,550	7,956	7,956
7	10,500	8,400	8,400	7,875	7,875	8,400	6,475	9,282	9,282
8	12,000	9,600	9,600	9,000	9,000	9,600	7,400	10,608	10,608
9	13,500	10,800	10,800	10,125	10,125	10,800	8,325	11,934	11,934
10	15,000	12,000	12,000	11,250	11,250	12,000	9,250	13,260	13,260
11	16,500	13,200	13,200	12,375	12,375	13,200	10,175	14,586	14,586
12	18,000	14,400	14,400	13,500	13,500	14,400	11,100	15,912	15,912
13	19,500	15,600	15,600	14,625	14,625	15,600	12,025	17,238	17,238



**UNIVERSITY OF CONNECTICUT**

**Fee Summary - Tier II**

	FY25	FY26	\$ Change	% Change	Note
<b>Acceptance Fees</b>					
Enrollment Deposit	\$ 400	\$ 400	\$ -	0.0%	
Law (day and evening)	\$ 250	\$ 250	\$ -	0.0%	
Law LLM	\$ 500	\$ 500	\$ -	0.0%	
Law SJD	\$ 500	\$ 500	\$ -	0.0%	
Executive MBA	\$ 1,800	\$ 1,800	\$ -	0.0%	
Full-time MBA	\$ 500	\$ 500	\$ -	0.0%	
Business BAPM	\$ 500	\$ 500	\$ -	0.0%	
Business MDFRM	\$ 500	\$ 500	\$ -	0.0%	
Certification in Risk Management	\$ 500	\$ 500	\$ -	0.0%	
Business MS HR Management	\$ 500	\$ 500	\$ -	0.0%	
Business ABC HR Management	\$ 100	\$ 100	\$ -	0.0%	
Social Work (MS)	\$ 60	\$ 60	\$ -	0.0%	
Doctor of Physical Therapy	\$ 1,000	\$ 1,000	\$ -	0.0%	
Nursing (MS)	\$ 1,000	\$ 1,000	\$ -	0.0%	
Nursing (MD/DMP)	\$ 1,000	\$ 1,000	\$ -	0.0%	
Nursing (DNP)	\$ 1,000	\$ 1,000	\$ -	0.0%	
Nursing (PhD)	\$ 1,000	\$ 1,000	\$ -	0.0%	
Nursing (CEIN)	\$ 1,000	\$ 1,000	\$ -	0.0%	
<b>Activity Fees</b>					
Storrs Graduate	\$ 16	\$ 16	\$ -	0.0%	
Law (day and evening)	\$ 82	\$ 83	\$ 1	0.0%	
Law LLM	\$ 82	\$ 83	\$ 1	0.0%	
Social Work	\$ 25	\$ 26	\$ 1	0.0%	
Summer Session (undergrad/graduate)*	\$ 16	\$ -	\$ (16)	0.0%	FY26 Only
<b>Application Fees</b>					
Storrs Undergraduate	\$ 80	\$ 80	\$ -	0.0%	
Regionals Undergraduate	\$ 80	\$ 80	\$ -	0.0%	
Law (day and evening)	\$ 60	\$ 60	\$ -	0.0%	
Law SJD	\$ 100	\$ 100	\$ -	0.0%	
Law LLM	\$ 75	\$ 75	\$ -	0.0%	
Social Work	\$ 55	\$ 55	\$ -	0.0%	
BGS	\$ 95	\$ 95	\$ -	0.0%	
Graduate	\$ 75	\$ 75	\$ -	0.0%	
Study Abroad	\$ 25	\$ 25	\$ -	0.0%	
<b>Bad Check Charge</b>	\$ 30	\$ 30	\$ -	0.0%	
<b>Continuous Registration Fees</b>					
Storrs Campus & Law Students	\$ 400	\$ 400	\$ -	0.0%	
Regional Campus Students	\$ 100	\$ 100	\$ -	0.0%	
<b>Course Credit by Exam - Storrs</b>	\$ 10	\$ 10	\$ -	0.0%	
<b>German Section Admin Charge (summer)</b>	\$ 350	\$ 350	\$ -	0.0%	
<b>ID Card Replacement</b>	\$ 30	\$ 30	\$ -	0.0%	
<b>Late Fees</b>					
Storrs Undergrad	\$ 150	\$ 150	\$ -	0.0%	
Storrs Graduate, MBA	\$ 150	\$ 150	\$ -	0.0%	
Law	\$ 150	\$ 150	\$ -	0.0%	
Social Work Step	\$ 150	\$ 150	\$ -	0.0%	
Social Work	\$ 150	\$ 150	\$ -	0.0%	
<b>Materials Fees - Majors (per semester)</b>					
Post-Baccalaureate Certificate in Pre-Medicine / Dentistry	\$ 1,500	\$ 1,500	\$ -	0.0%	

**UNIVERSITY OF CONNECTICUT**

**Fee Summary - Tier II**

	FY25		FY26		\$ Change		% Change		Note
<b>Reinstatement Fees</b>									
Storrs - Graduate & MBA	\$ 65	\$	\$ 65	\$	-		0.0%		
Law	\$ 10	\$	\$ 10	\$	-		0.0%		
Senior Citizen Audit Fee - Credit Ext.	\$ 15	\$	\$ 15	\$	-		0.0%		
Social Work Enrollment Fee Step Program	\$ 45	\$	\$ 45	\$	-		0.0%		
Study Abroad - All	\$ 475	\$	\$ 475	\$	-		0.0%		
<b>Summer Enrollment Fees</b>									
Degree	\$ 45	\$	\$ 45	\$	-		0.0%		
Non-Degree	\$ 65	\$	\$ 65	\$	-		0.0%		
<b>Other Fees</b>									
VISA Compliance Fee	\$ 700	\$	\$ 900	\$	200		28.6%		
Barnes and Noble First Day (waivable)	\$ 285	\$	\$ 285	\$	-		0.0%		

\*Will not be charged in FY26 as the fee and programming are being evaluated

**University of Connecticut**  
**Summary of Recommended adjustments to Housing and Dining Rates**

<b>Storrs Campus Rates</b>				
<b>Rate</b>	<b>Room Type</b>	<b>FY25</b>	<b>FY26</b>	<b>Dollar Increase</b>
Rate 1	Regular Double	\$7,850	\$8,066	\$216
	Triple Traditional Residence Hall			
	Quad Four Person Room			
	Northwood Apartments (Double in 2 Bedroom/3 Person)			
Rate 2	Werth Hall Double	\$8,228	\$8,886	\$658
Rate 3	Busby/Garrigus Suites Triples	\$8,628	\$9,318	\$690
Rate 4	Busby/Garrigus/South Suites Double	\$9,830	\$10,616	\$786
	Husky Village			
	Northwood Apartments (Single in 2 Bed/2 Person)			
	Regular Single			
	Shippee C Section			
Rate 5	Werth Hall Single	\$9,984	\$11,182	\$1,198
	New South Campus Single (New)			
Rate 6	Busby/Garrigus/South Suites Single	\$10,476	\$11,733	\$1,257
	Charter Oak/Hilltop Apartments 2 Bedroom/4 Person			
	Hilltop Apartments Double Efficiency			
	New South Campus (Single, Semi Suite Single, Full Suite Double)			
	The Oaks Apartment - 2 bedroom/3 person *			
Rate 7	Charter Oak/Hilltop Apartments 4 Bedroom/4 Person	\$13,226	\$13,887	\$661
Rate 8	Charter Oak/Hilltop Apartments – 2 Bedroom/2 Person (new)	\$15,662	\$16,092	\$430
	The Oaks Apartment- 3 bedroom/3 person *			
	The Oaks Apartment- 2 bedroom/2 person *			

<b>Stamford Campus Rates - Board not required</b>				
<b>Rate</b>	<b>Room Type</b>	<b>FY25</b>	<b>FY26</b>	<b>Dollar Increase</b>
Stamford Rate 1	Standard Shared Bedroom	\$11,698	\$12,020	\$322
Stamford Rate 2	Premium Shared Bedroom	\$14,188	\$14,578	\$389
Stamford Rate 3	Penthouse Shared Bedroom	\$14,818	\$15,226	\$408

<b>Storrs Campus Dining Rates</b>				
<b>Rate</b>	<b>Plan Type</b>	<b>FY25</b>	<b>FY26</b>	<b>Dollar Increase</b>
Rate 1	Ultimate	\$6,840	\$7,028	\$188
Rate 2	Value	\$6,530	\$6,710	\$181
Rate 3	Custom	\$6,192	\$6,362	\$170

\* The Oaks apartments are contracted for an 11-month period. An additional fee of \$1,848 will be assessed on the fall and spring fee bills to account for the extended period of access.

# FY26 Fee Proposal



Student Town Hall

November 13, 2024

**UConn**

# Goals and Considerations

- For academic year '25/26, the administration will present a one-year rate proposal to hold tuition flat and minimal fee increases to keep pace with rising costs. (Storrs UG proposal = \$292 vs \$520 required to eliminate subsidy)
- Tuition has not been held flat since the year 2000; a pause will slow the growth of the tuition rate to ensure that UConn remains an economic value for students and families.
- The University will continue to address significant budget deficits in the next year, but covering this gap with tuition alone is not a viable strategy.
- We will work to identify opportunities to increase revenues through enrollment growth, philanthropy, and external grants and partnerships while working to reduce costs.
- The necessary resources will be provided to maintain high-quality education and student support services.

# Timeline / Process

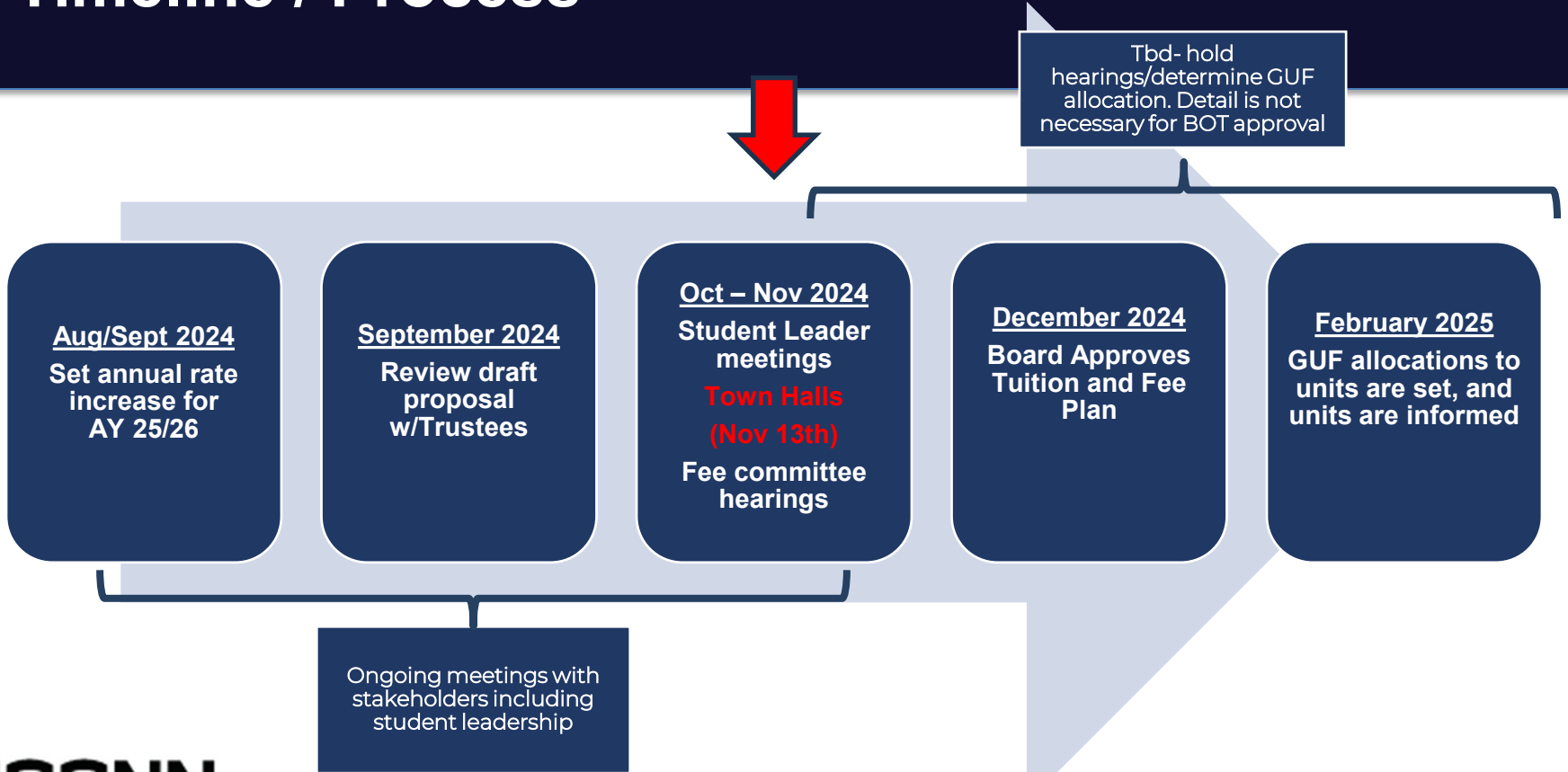

# General University Fee

## The fee supports student-related programs and institutional services of those programs

- Athletics, including Student Tickets
- Career Development Center
- Jorgensen Performing Arts Center
- Marching Band
- One Card
- Student Activities
- Cultural Centers

Last Rate Change: 2024

Current Rate: \$1,570/ \$124/ \$1,072

Proposed Rate: \$1,668/ \$132/ \$1,170  
(Storrs/Regional/Graduate)



## Proposal Summary

Estimated Expenses	\$37M
Required Fee Increase	\$250
<u>Proposed Fee Increase</u>	
Storrs Undergrad	\$98
Regional Undergrad	\$8
Storrs Graduate	\$98

SASFAC will hold budget hearings in November 2024 with GUF-supported units and make allocation recommendations in January 2025.

# Student Health and Wellness

**Student Health and Wellness offers a comprehensive set of services to ensure the health and well-being of our students**

- Immediate Care
- Alcohol and other Substance Support
- Allergy Clinic
- Injury & Illness

- Pharmacy
- Preventive Care & Health Screenings
- Radiology
- Recovery Support Services
- Sexual Health & Reproductive Care
- Sports Medicine
- Travel Medicine
- Immunizations
- Lab Testing
- Mental Health
- Nutrition
- Overnight Care



Proposal Summary	
Estimated Expenses	\$25M
Required Fee Increase	\$107
<u>Proposed Fee Increase</u>	
Storrs Undergrad	\$80
Regional Undergrad	\$8
Storrs Graduate	\$80

Last Rate Change: 2024  
 Current Rate: \$776/ \$80/ \$776  
 Proposed Rate: \$856/ \$88/ \$856  
 (Storrs/Regional/Graduate)



# Infrastructure Maintenance Fee

The University continues to make improvements to campus and modernize its infrastructure

## Infrastructure Maintenance Fee

- Directly supports maintenance costs for classrooms, buildings, and infrastructure and payments towards select debt-financed infrastructure improvements
- Preventative maintenance of assets is required to drive down operational expenses

Last Rate Change: 2024

Current Rate: \$618/ \$618/ \$618

Proposed Rate: \$688/ \$688/ \$688  
(Storrs/Regional/Graduate)



## Proposal Summary

Estimated Expenses	\$18M
Required Fee Increase	\$70
<u>Proposed Fee Increase</u>	
Storrs Undergrad	\$70
Regional Undergrad	\$70
Storrs Graduate	\$70

# Transit Fee



## Students can ride on campus or across the State

### Transit Fee

- Funds campus shuttle bus service.
- Students receive access to the State's UPass program, which provides free CT Transit passes for train and bus service throughout the State.

Last Rate Change: 2024  
 Current Rate: \$194/ \$54/ \$194  
 Proposed Rate: \$212/ \$58/ \$212  
 (Storrs/Regional/Graduate)

### Proposal Summary

Estimated Expenses	\$6M
Required Fee Increase	\$39
<u>Proposed Fee Increase</u>	
Storrs Undergrad	\$18
Regional Undergrad	\$4
Storrs Graduate	\$18

# Technology Fee

## Technology Fee

Provides all students with:

- Classroom technology for multi-modal learning
- Software for teaching and learning
- Microsoft 365
- Media-related library services

Last Rate Change: 2024

Current Rate: \$184/ \$184/ \$184

Proposed Rate: \$204/ \$204/ \$204  
(Storrs/Regional/Graduate)

**Classroom upgrades provide professors the ability to instruct hybrid audiences**

**Typical Classroom Before**

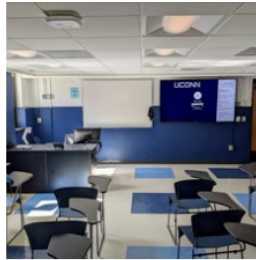

**Typical Classroom After**



## **Proposal Summary**

Estimated Expenses	\$7M
Required Fee Increase	\$54
<u>Proposed Fee Increase</u>	
Storrs Undergrad	\$20
Regional Undergrad	\$20
Storrs Graduate	\$20

# Student Activity Fees

The Student Activity and Student Government Fees fund student activities directly and are not included in the University's operating budget.

As part of the student fee process, the recommended fee increase may be less than the indicated amounts or may not be increased at all. In some instances, campuses or groups might choose not to request an increase.

Proposal Summary	'24-25	Proposed CAPPED Increase '25-26
Storrs (Student Activity Fee)	\$192	\$198
Regional (Student Government Fee)	\$60/\$70/\$80	\$62/\$72/\$82
Graduate (Student Activity Fee)	\$32	\$34



Current Student Government Fees by Campus:  
Hartford (\$60), Avery Point and Waterbury (\$70) and Stamford (\$80)

# Housing and Dining

**A 2.75% increase to the lowest housing rate will be used for continued investment in the on-campus housing program. All dining rates will increase by 2.75%. A full rate schedule will be available in December**



Rankings by total Room and Board Rates AY24/25				
	School	Room Rate	Board Rate	Room & Board
(1)	Northeastern University	\$ 12,688	\$ 8,600	\$ 21,288
(2)	Boston University	\$ 12,180	\$ 6,840	\$ 19,020
(3)	Stony Brook	\$ 11,588	\$ 7,192	\$ 18,780
(4)	Fordham University	\$ 11,000	\$ 7,660	\$ 18,660
(5)	Boston College*			\$ 17,930
(6)	Quinnipiac University*			\$ 17,260
(7)	University of Massachusetts	\$ 9,062	\$ 7,647	\$ 16,709
(8)	University of Maryland	\$ 9,562	\$ 6,097	\$ 15,659
(9)	University of Delaware	\$ 8,740	\$ 6,646	\$ 15,386
(10)	University of Rhode Island	\$ 9,110	\$ 5,350	\$ 14,460
(11)	<b>University of Connecticut</b>	<b>\$ 7,850</b>	<b>\$ 6,530</b>	<b>\$ 14,380</b>
(12)	Rutgers University*			\$ 14,376
(13)	University of North Carolina	\$ 7,736	\$ 6,068	\$ 13,804
(14)	University of Vermont*			\$ 13,776

\*do not report split between room and board

# Visa Compliance Fee



The Visa Compliance Fee is paid by enrolled students on university-sponsored F-1 and J-1 visas. It supports the costs of services provided to international students at Storrs and regional campuses.

- ❑ Graduate students who hold Graduate Assistantships and exchange students attending UConn through bilateral exchange agreements are exempt from the fee.
- ❑ Increase from \$350/semester to \$450/semester or \$200 per academic year.
- ❑ The Visa Compliance Fee has not increased since its inception in 2017.
- ❑ Results in an annualized increase of 3.2% over the eight years since the fee's inception.

# Undergraduate Storrs

## Proposal:

- ❑ Tuition will remain unchanged. Various fees will increase and be allocated to student support services, including SHaW, GUF, transit, and the student activity fee.
- ❑ The Infrastructure Maintenance Fee (IMF) and Technology Fee will increase to reflect rising facility and technology costs.
- ❑ The lowest housing and dining options will increase by 2.75%.

Academic Year	'24-25	Proposed '25-26	Change
Tuition (In-State)	\$17,010	\$17,010	\$0
General University Fee	1,570	1,668	98
Student Health Services	776	856	80
Student Recreation Center Fee	500	500	0
Infrastructure Maintenance Fee	618	688	70
Technology Fee	184	204	20
Transit Fee	194	212	18
Student Activity Fees	192	198	6
<b>Total, Commuting Student (In-State)</b>	<b>\$21,044</b>	<b>\$21,362</b>	<b>\$292 / 1.4%</b>

<b>Total, Commuting Student (Out-of-State)</b>	<b>\$43,712</b>	<b>\$44,004</b>	<b>\$292 / 0.7%</b>
--	-----------------	-----------------	---------------------

Regular Double Room/ Value Meal Plan	\$14,380	\$14,776	\$396
<b>Total, On-Campus Student (In-State)</b>	<b>\$35,424</b>	<b>\$36,112</b>	<b>\$688 / 2.0%</b>

<b>Total, On-Campus Student (Out-of-State)</b>	<b>\$58,092</b>	<b>\$58,780</b>	<b>\$688 / 1.2%</b>
--	-----------------	-----------------	---------------------

# Undergraduate Regionals

## Proposal:

- ❑ Regional Campus students will see a \$112 increase for commuting students.
- ❑ Tuition will remain unchanged.- Various fees will increase and be allocated to student support services, including SHaW, GUF, transit, and the student activity fee.
- ❑ The Infrastructure Maintenance Fee (IMF) and Technology Fee will increase to reflect rising facility and technology costs.

Academic Year	'24-25	Proposed '25-26	Change
Tuition (In-State)	\$17,010	\$17,010	\$0
General University Fee	124	132	8
Student Health Services	80	88	8
Infrastructure Maintenance Fee	618	688	70
Technology Fee	184	204	20
Transit Fee	54	58	4
Student Government*	70	72	2
<b>Total, Commuting Student (In-State)</b>	<b>\$18,140</b>	<b>\$18,252</b>	<b>\$112 / 0.7%</b>

<b>Total, Commuting Student (Out-of-State)</b>	<b>\$40,808</b>	<b>\$40,920</b>	<b>\$112 / 0.3%</b>
--	-----------------	-----------------	---------------------

\*Student Government Fees are different at Hartford (\$60) and Stamford (\$80)

Housing available at Stamford Campus - rates will be available in December



# Graduate Storrs

## Proposal:

- ❑ Tuition will remain unchanged. Various fees will increase and be allocated to student support services, including SHaW, GUF, transit, and the student activity fee.
- ❑ The IMF and Technology Fee will increase to reflect rising facility and technology costs.

Academic Year	'24-25	Proposed '25-26	Change
Tuition (In-State)	\$19,512	\$19,512	\$0
General University Fee	1,072	1,170	98
Student Health Services	776	856	80
Student Recreation Center Fee	400	400	0
Infrastructure Maintenance Fee	618	688	70
Technology Fee	184	204	20
Transit Fee	194	212	18
Student Activity Fee	32	34	2
Graduate Matriculation Fee	84	84	0
<b>Total, Commuting Student (In-State)</b>	<b>\$22,872</b>	<b>\$23,160</b>	<b>\$288 / 1.3%</b>

<b>Total, Commuting Student (Out-of-State)</b>	<b>\$44,784</b>	<b>\$45,072</b>	<b>\$288 / 0.7%</b>
--	-----------------	-----------------	---------------------

Room Fee (Rate 4*) / Value Board	\$16,360	\$16,810	\$450
<b>Total, On-Campus Student (In-State)</b>	<b>\$39,232</b>	<b>\$39,970</b>	<b>\$738 / 1.9%</b>

<b>Total, On-Campus Student (Out-of-State)</b>	<b>\$61,144</b>	<b>\$61,882</b>	<b>\$738 / 1.3%</b>
--	-----------------	-----------------	---------------------

### Note- GAs receive waivers/credit for:

- ❑ IMF, GUF (\$600), Student Recreation, and the Graduate Matriculation Fee.
- ❑ GAs will see a \$218 increase, 1.0% for in-state and 0.5% for out-of-state commuters.

Fall GA Headcount	FY19	FY24	Change
Research/Other	657	848	29%
Teaching	1,215	1,265	4%
<b>Total Graduate Assistants</b>	<b>1,873</b>	<b>2,113</b>	<b>13%</b>

# Summary of Fees

Undergraduate Storrs	Undergraduate Regionals	Graduate Tuition Based Storrs	Graduate Tuition Based Regionals	Professional Based Programs
(Undergraduate Storrs Rate Schedule) Slide 12	(Undergraduate Regional Rate Schedule) Slide 13  Technology and IMF are equal to Storrs. All others at a reduced rate from Storrs or excluded from regionals	(Storrs Rate Schedule) Slide 14  IMF and Technology are equal to Undergraduate Storrs, and all others are reduced.  GAs receive specific waivers	Slide 15  Pay fees based on the regional campus graduate rate.  A limited number of programs fall under this rate schedule	Professional-based programs pay a comprehensive per-credit rate. No additional fees are assessed to these fee-based programs*  *IMF is embedded in some business program fees.

# Professional Programs

School of Business – Professional Programs per Credit			
Academic Year	'24-25	Proposed '25-26	Change
MBA	\$1,150	\$1,200	\$50
MS in Human Resource Management	\$1,150	\$1,200	\$50
MS in Social Responsibility Impact in Business	\$1,150	\$1,200	\$50
ABC in Digital Marketing Strategy	\$1,150	\$1,200	\$50
ABC in Health Care Analytics	\$1,150	\$1,200	\$50
ABC in Health Care Finance and Insurance	\$1,150	\$1,200	\$50
ABC in Human Resource Management	\$1,150	\$1,200	\$50
Certificate in Corporate and Regulatory Compliance	\$1,150	\$1,200	\$50
Long-term Health Care Management Certificate	\$1,150	\$1,200	\$50
MS in Accounting (MSA)	\$1,075	\$1,125	\$50
Accounting Fundamentals Certificate (AFC)	\$1,075	\$1,125	\$50
Advanced Business Certificate (ABC) in Accounting Analytics	\$1,075	\$1,125	\$50

# Appendix

Inflation			
Year	HEPI	CPI	National Rental
2013	1.6%	1.50%	2.70%
2014	3.0%	1.60%	5.62%
2015	2.0%	0.10%	3.58%
2016	1.3%	1.30%	6.63%
2017	3.4%	2.10%	4.69%
2018	2.9%	2.40%	2.61%
2019	2.5%	1.80%	5.63%
2020	2.0%	1.20%	16.60%
2021	2.7%	4.70%	13.50%
2022	5.2%	8.00%	12.20%
2023	4.0%	4.10%	3.80%
2024	3.4%	3.20%	3.50%

# ATTACHMENT 5

---



December 11, 2024

TO: Members of the Board of Trustees

FROM: Jeffrey P. Geoghegan, CPA   
Executive Vice President for Finance & Chief Financial Officer

Anne D'Alleva   
Provost and Executive Vice President for Academic Affairs

RE: School of Dental Medicine Tuition and Fees Rates for Academic Years 2026 and 2027

RECOMMENDATION:

The Board of Trustees approves a 4.5% tuition and a 3.0% professional school fee increase for the next two academic years (fiscal years 2026 and 2027) for the School of Dental Medicine

RESOLUTION:

“Be it resolved that the School of Dental Medicine Tuition and Professional Fees for the next two Academic Years (fiscal years 2026 and 2027) shall be set according to the attached Rate Schedule.”

BACKGROUND:

The tuition and fee rates for the School of Dental Medicine (SODM) are set by the Board of Trustees upon the recommendation of the Board of Directors. Fifteen percent (15%) of tuition revenue will continue to be set aside for need based financial aid as scholarship and the same percentage (15%) of fee income is available for loans.

This proposal contains a 4.5% increase on tuition and a 3.0% professional school fee increase for the next two academic years (fiscal years 2026 and 2027). Based on latest available data, the SODM in-state resident rates are at the 45th percentile among public dental schools. Only a small number of students actually pay the non-resident rate given the opportunity to convert to resident status after one year of attendance.

While UConn SODM graduates have lower indebtedness, especially when compared to other dental school graduates, we continue to carefully monitor student debt and remain focused on attracting the best qualified applicants as future healthcare providers for Connecticut.

**SCHOOL OF DENTAL MEDICINE  
PROPOSED TUITION AND FEE SCHEDULE FOR THROUGH AY 2026/2027**

School of Dental Medicine Tuition		Current	PROPOSED			PROPOSED		
		AY 24-25 Base	%	AY 25-26 Amount		%	AY 26-27 Amount	
	Resident	\$42,943	4.50%	\$1,932	\$44,875	4.50%	\$2,019	\$46,895
	Non-Resident	\$86,686	4.50%	\$3,901	\$90,587	4.50%	\$4,076	\$94,663
	Regional **	\$75,151	4.50%	\$3,382	\$78,533	4.50%	\$3,534	\$82,067
<b>Professional School Fee</b>								
	Resident	\$3,060	3.00%	\$92	\$3,152	3.00%	\$95	\$3,246
	Non-Resident	\$3,060	3.00%	\$92	\$3,152	3.00%	\$95	\$3,246
	Regional	\$3,060	3.00%	\$92	\$3,152	3.00%	\$95	\$3,246
<b>TOTAL TUITION &amp; FEES</b>								
	<b>Resident</b>	<b>\$46,003</b>	<b>4.40%</b>	<b>\$2,024</b>	<b>\$48,027</b>	<b>4.40%</b>	<b>\$2,114</b>	<b>\$50,141</b>
	<b>Non-Resident</b>	<b>\$89,746</b>	<b>4.45%</b>	<b>\$3,993</b>	<b>\$93,739</b>	<b>4.45%</b>	<b>\$4,171</b>	<b>\$97,910</b>
	<b>Regional</b>	<b>\$78,211</b>	<b>4.44%</b>	<b>\$3,474</b>	<b>\$81,685</b>	<b>4.44%</b>	<b>\$3,629</b>	<b>\$85,313</b>
<b>Health Insurance**</b>								
	Resident	\$3,248	5.00%	\$162	\$3,410	5.00%	\$171	\$3,581
	Non-Resident	\$3,248	5.00%	\$162	\$3,410	5.00%	\$171	\$3,581
	Regional	\$3,248	5.00%	\$162	\$3,410	5.00%	\$171	\$3,581

TOTAL TUITION, FEES AND HEALTH INSURANCE**		AY 24-25	AY 25-26		AY 26-27			
			%	Amount	Amount	%	Amount	
	Resident	<b>\$49,251</b>	4.44%	<b>\$2,187</b>	<b>\$51,438</b>	4.44%	<b>\$2,284</b>	<b>\$53,722</b>
	Non-Resident	<b>\$92,994</b>	4.47%	<b>\$4,155</b>	<b>\$97,149</b>	4.47%	<b>\$4,341</b>	<b>\$101,491</b>
	Regional	<b>\$81,459</b>	4.46%	<b>\$3,636</b>	<b>\$85,095</b>	4.46%	<b>\$3,799</b>	<b>\$88,894</b>

**Notes:**

\*\* The regional rate for tuition must be 175% the resident rate.

\*\* The health insurance rate are estimates based on recent trends data and students can opt out if they have other coverage



# Tuition and Fees Proposal Academic Years 25-26 & 26-27





- Proposal for a 4.5% increase in tuition and a 3.0% increase in fees each year for the next two academic years
- While tuition and fees is increasing, the UConn SODM tuition and fees remains exceptionally competitive and below the 50<sup>th</sup> percentile for US public dental schools
- UConn graduates have one of the lowest total educational debt of any school; the average graduate has less than ½ of the debt of the average US graduate (now more than \$330,000)

- Our admissions yield remains very high
  - Class of 2028: 73 offers for 51 matriculants
  - 70% admission yield
- Accepted students who decline our offer of admission usually attend schools that are significantly higher in tuition & fees

**SCHOOL OF DENTAL MEDICINE  
PROPOSED TUITION AND FEE SCHEDULE FOR THROUGH AY 2026/2027**

		Current	PROPOSED			PROPOSED		
School of Dental Medicine		AY 24-25	AY 25-26			AY 26-27		
Tuition		Base	%	Amount		%	Amount	
	Resident	\$42,943	4.50%	\$1,932	\$44,875	4.50%	\$2,019	\$46,895
	Non-Resident	\$86,686	4.50%	\$3,901	\$90,587	4.50%	\$4,076	\$94,663
	Regional **	\$75,151	4.50%	\$3,382	\$78,533	4.50%	\$3,534	\$82,067
Professional School Fee								
	Resident	\$3,060	3.00%	\$92	\$3,152	3.00%	\$95	\$3,246
	Non-Resident	\$3,060	3.00%	\$92	\$3,152	3.00%	\$95	\$3,246
	Regional	\$3,060	3.00%	\$92	\$3,152	3.00%	\$95	\$3,246
TOTAL TUITION & FEES								
	Resident	<b>\$46,003</b>	<b>4.40%</b>	<b>\$2,024</b>	<b>\$48,027</b>	<b>4.40%</b>	<b>\$2,114</b>	<b>\$50,141</b>
	Non-Resident	<b>\$89,746</b>	<b>4.45%</b>	<b>\$3,993</b>	<b>\$93,739</b>	<b>4.45%</b>	<b>\$4,171</b>	<b>\$97,910</b>
	Regional	<b>\$78,211</b>	<b>4.44%</b>	<b>\$3,474</b>	<b>\$81,685</b>	<b>4.44%</b>	<b>\$3,629</b>	<b>\$85,313</b>
Health Insurance**								
	Resident	\$3,248	5.00%	\$162	\$3,410	5.00%	\$171	\$3,581
	Non-Resident	\$3,248	5.00%	\$162	\$3,410	5.00%	\$171	\$3,581
	Regional	\$3,248	5.00%	\$162	\$3,410	5.00%	\$171	\$3,581

TOTAL TUITION, FEES AND HEALTH INSURANCE**		AY 24-25	AY 25-26			AY 26-27		
	Resident	<b>\$49,251</b>	4.44%	<b>\$2,187</b>	<b>\$51,438</b>	4.44%	<b>\$2,284</b>	<b>\$53,722</b>
	Non-Resident	<b>\$92,994</b>	4.47%	<b>\$4,155</b>	<b>\$97,149</b>	4.47%	<b>\$4,341</b>	<b>\$101,491</b>
	Regional	<b>\$81,459</b>	4.46%	<b>\$3,636</b>	<b>\$85,095</b>	4.46%	<b>\$3,799</b>	<b>\$88,894</b>

**Notes:**

\*\* The regional rate for tuition must be 175% the resident rate.

\*\* The health insurance rate are estimates based on recent trends data and students can opt out if they have other coverage



# ATTACHMENT 6

---

December 11, 2024

TO: Members of the Board of Trustees 

FROM: Jeffrey P. Geoghegan, CPA  
Executive Vice President for Finance & Chief Financial Officer

RE: Authorization to Execute Firm Electricity Purchase Contracts Resulting from  
Competitive Pricing Solicitation

RECOMMENDATION:

That the Board of Trustees authorizes the Administration to execute contracts with a third-party electricity supplier for the purchase of electricity and attributes for the Storrs, Regional (excluding Avery Point), and Health Center campuses for up to five (5) years not to exceed \$30 million per year.

BACKGROUND:

In 2020 the University and Connecticut State Colleges and Universities Board of Regents (CT BoR) utilized a Connecticut Department of Administrative Services contract authorizing reverse energy auctions to lock in favorable and firm electricity and attribute rates through April 2025. This followed previous successful reverse auctions in 2016, 2013, and 2009 when the University, CT BoR and other state agencies utilized a Connecticut Department of Administrative Services contract authorizing reverse energy auctions to lock in favorable and firm electricity and attribute rates from third-party suppliers. The Connecticut Department of Administrative Services contract authorizing reverse energy auctions has expired, which requires competitive pricing solicitation.

The University and UConn Health plan to participate in a competitive pricing solicitation prior to the April 30, 2025, expiration of this contract to determine whether they can again lock in favorable and firm electricity and attribute rates through 2030 from third-party suppliers. Should the reverse auction fail to yield favorable pricing terms, attributes will be acquired by a separate solicitation and electricity will be purchased via the standard or "last resort" offers provided through the local distribution companies, subjecting the University to seasonal price volatility and potentially higher annual costs overall.



# FY 2026 ENERGY BUDGET

## University of Connecticut

The Health Center's FY 2026 energy budget totals **\$18.8 million**.

The total represents a 20% increase over the FY 2025 Rev1 budget total (\$15.5 million).

The total represents a 50% increase over the three-year rolling average of actual cost (\$12.4 million).

## UCH Energy Costs (Actuals & Budget Forecast): FY 2022 – FY 2026

Cost Category	FY 2022 Actuals	FY 2023 Actuals	FY 2024 Actuals	FY 2025 Rev1 Budget	FY 2026 Rev0 Budget
Natural Gas Supply	\$1,830,928	\$2,397,743	\$1,315,322	\$1,642,552	\$1,694,504
Natural Gas Delivery	\$672,914	\$649,608	\$772,640	\$777,328	\$841,822
Grid Electricity Supply	\$5,456,703	\$5,288,591	\$5,397,115	\$5,600,823	\$7,891,441
Grid Electricity Delivery	\$4,689,241	\$4,169,457	\$4,557,351	\$7,472,602	\$8,325,149
<b>Total Energy Cost</b>	<b>\$12,650,571</b>	<b>\$12,505,399</b>	<b>\$12,042,428</b>	<b>\$15,493,305</b>	<b>\$18,752,915</b>

# ASSUMPTIONS | Eversource Electric FMCC

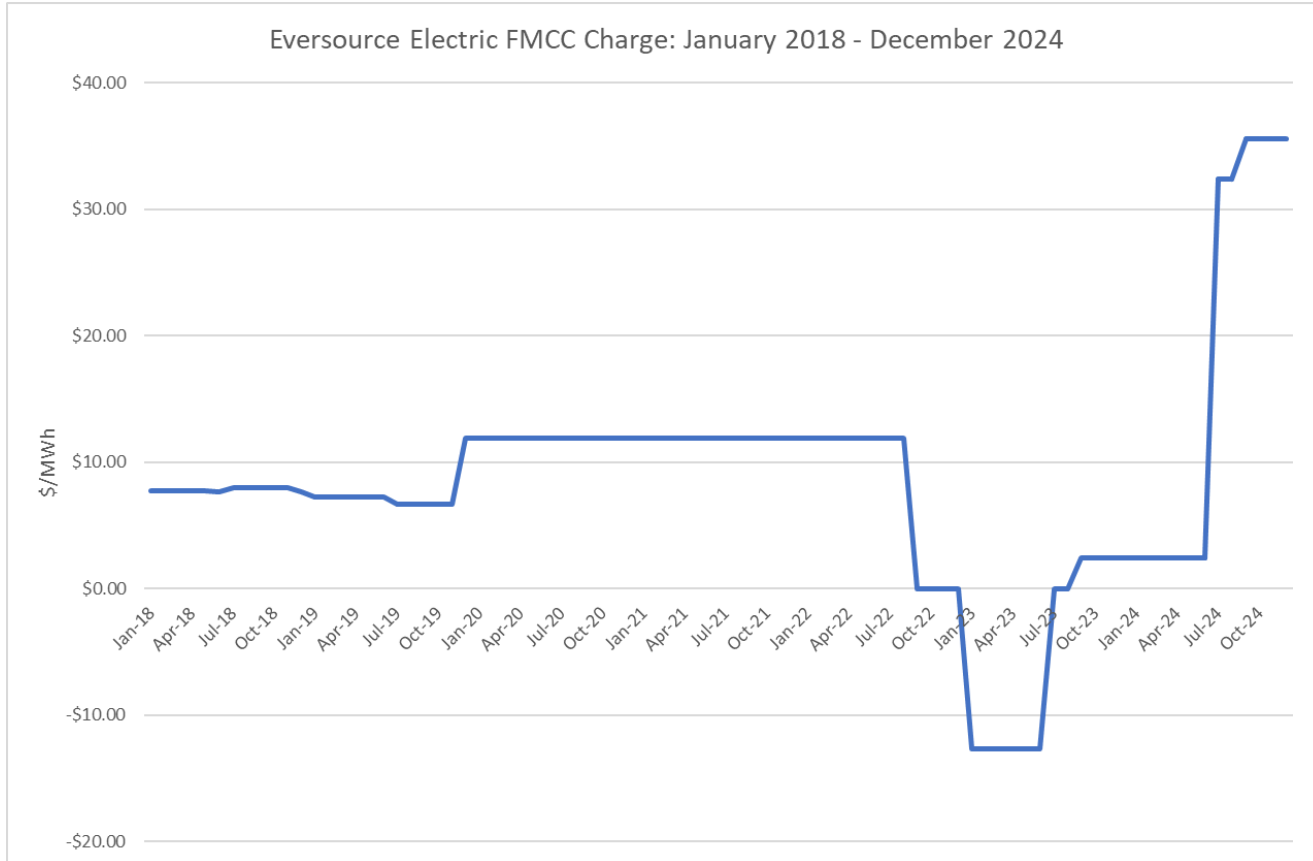

← **Rev0 Budget  
(Nov 2024)**

} **\$5/MWh change  
= \$400,000/year**



# ASSUMPTIONS | Electric Supply Pricing

The Health Center's four-year electric supply contract with Constellation runs through April 2025.

We have projected a nearly 50% increase in the new price for FY 2026, rising from \$68.10 per MWh to **\$100 per MWh**.

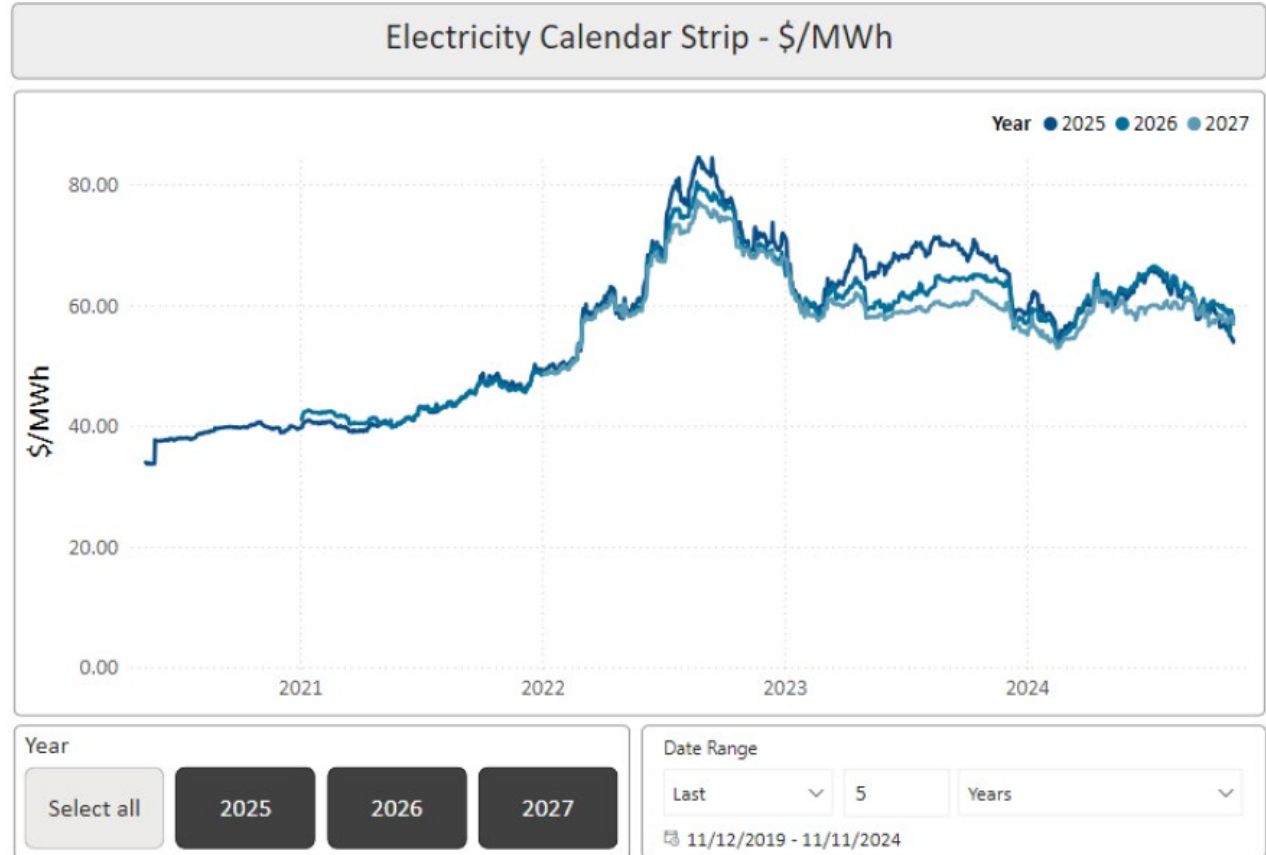

# ASSUMPTIONS | CNG Gas Supply Pricing



Average Annualized  
CNG Default Supply

FY21: \$3.83 per MMBtu

FY22: \$5.60 per MMBtu

FY23: \$7.59 per MMBtu

FY24: \$4.11 per MMBtu

FY25 Rev1: \$5.20

FY26 Rev0: \$5.41

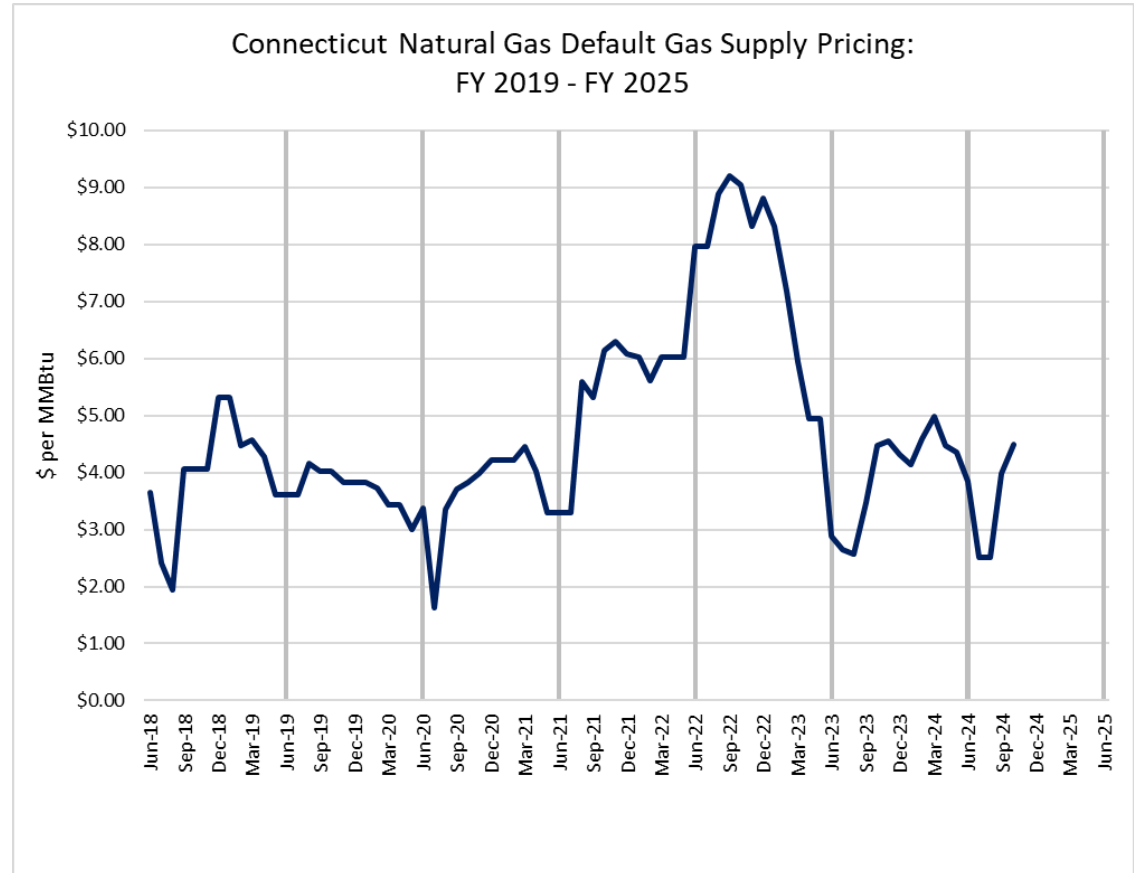

The Health Center's FY 2026 energy budget totals **583,000 MMBtu**.

The total represents a 2% increase compared to actual use in FY 2024 (573,000 MMBtu).

The total represents a <1% reduction from the three-year rolling average of actual use.

## UCH Energy Usage (Actuals & Budget Forecast): FY 2022 – FY 2026

Usage Category	FY 2022 Actuals	FY 2023 Actuals	FY 2024 Actuals	FY 2025 Budget Rev1	FY 2026 Budget Rev0
Electricity (kWh) Main Account	68,207,990	66,373,440	62,627,910	67,290,715	67,000,675
Electricity (kWh) Other Accounts	11,919,811	11,285,745	11,624,879	11,906,640	11,913,734
Gas (MMBtu) Main Accounts	255,638	247,569	245,135	250,163	245,394
Gas (MMBtu) Other Accounts	71,342	61,814	74,895	66,127	68,001
<b>Total Energy Use (MMBtu)</b>	<b>600,376</b>	<b>574,356</b>	<b>573,381</b>	<b>586,511</b>	<b>582,651</b>

The broader UCONN FY 2026 energy budget totals **\$24.2 million**.

The total represents a 7% increase over the FY 2025 Rev1 budget total (\$22.6 million).

The total represents a 2% increase over the three-year rolling average of actual cost (\$23.7 million).

## UCONN Energy Costs (Actuals & Budget Forecast): FY 2022 – FY 2026

Cost Category	FY 2022 Actuals	FY 2023 Actuals	FY 2024 Actuals	FY 2025 Rev1 Budget	FY 2026 Rev0 Budget
Natural Gas Supply	\$10,358,310	\$16,370,881	\$13,390,774	\$10,941,396	\$11,144,823
Natural Gas Delivery	\$2,529,809	\$2,079,849	\$2,200,380	\$2,232,103	\$2,415,253
Grid Electricity Supply	\$3,061,528	\$2,623,945	\$2,210,188	\$2,942,365	\$3,711,818
Grid Electricity Delivery	\$3,303,760	\$3,647,265	\$4,449,240	\$4,427,319	\$5,119,968
#2 Oil	\$1,207,356	\$1,251,457	\$530,921	\$1,425,839	\$1,231,883
Hartford District Energy	\$556,694	\$612,310	\$614,121	\$645,822	\$619,906
<b>Total Energy Cost</b>	<b>\$21,017,457</b>	<b>\$26,585,707</b>	<b>\$23,395,624</b>	<b>\$22,614,843</b>	<b>\$24,243,650</b>

# ASSUMPTIONS | CUP Natural Gas Pricing



Average Annualized  
Delivered CUP Gas

FY21: \$5.18 per MMBtu

FY22: \$5.73 per MMBtu

FY23: \$8.79 per MMBtu

FY24: \$7.34 per MMBtu

FY25 Rev1: \$6.02

FY26 Rev0: \$5.99

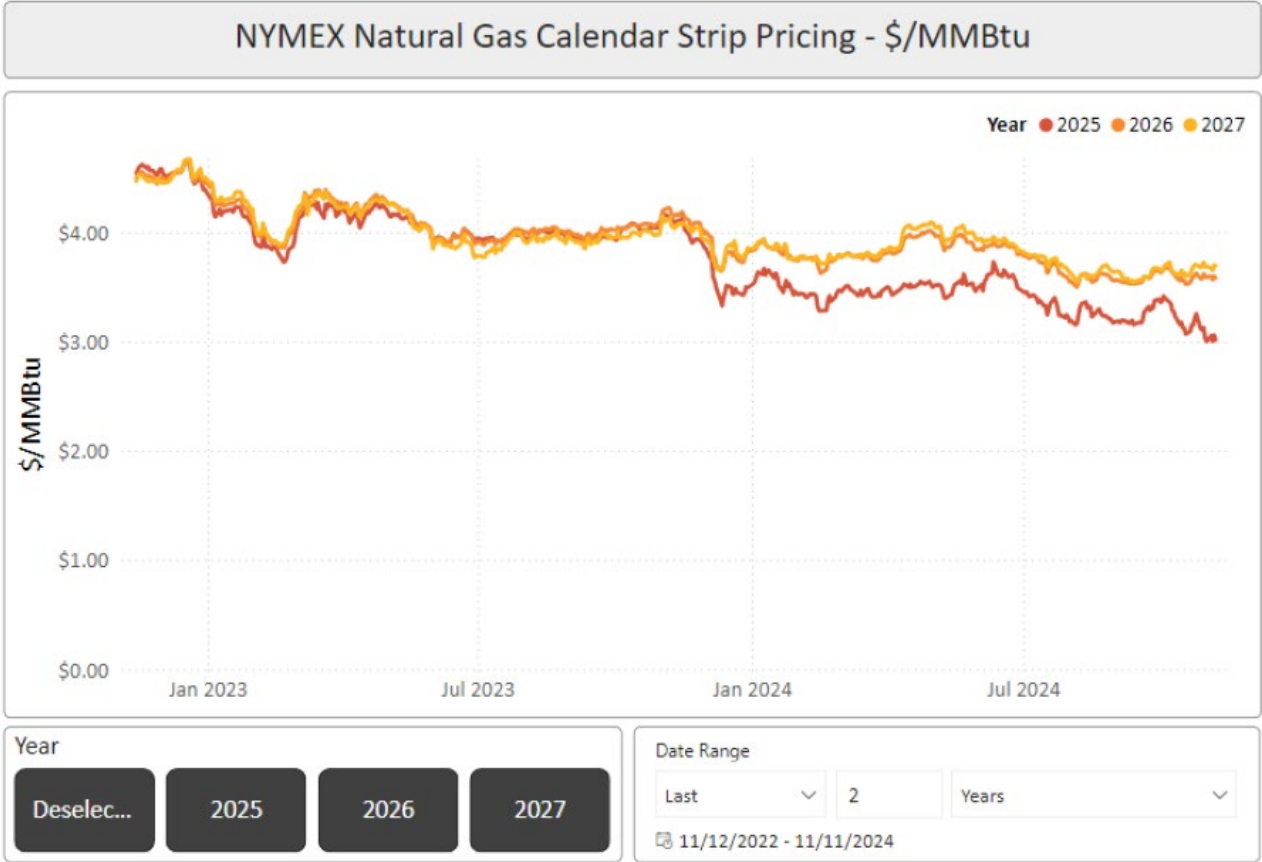

# ASSUMPTIONS | CUP Natural Gas Pricing

To date, UCONN has hedged 980,000 MMBtu of gas supply for the CUP in FY 2026 at an average weighted price of \$3.47 per MMBtu.

Remaining gas volumes have been budgeted based on Tetco M3 and NYMEX futures for non-fixed gas and IS volumes respectively.

5-Year Storage Differential vs. NYMEX Rolling 12 Month Strip Futures - \$/MMBtu

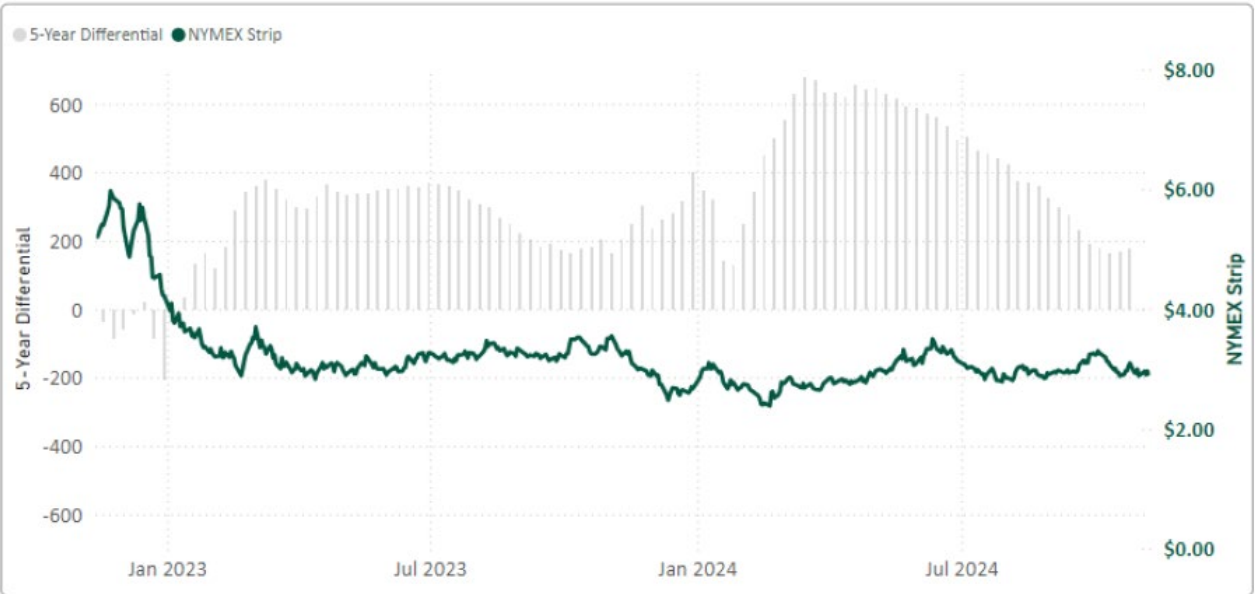

NYMEX Futures Contract Options

12

24

36

Prompt

Date Range

Last

2

Years

11/12/2022 - 11/11/2024

The broader UCONN FY 2026 energy budget totals **2.18m MMBtu**.

The total represents a <1% increase to actual usage in FY 2024.

The total represents a 1% increase above the three-year rolling average of actual use (2.16 million MMBtu).

## UCONN Energy Usage (Actuals & Budget Forecast): FY 2022 – FY 2026

Usage Category	FY 2022 Actuals	FY 2023 Actuals	FY 2024 Actuals	FY 2025 Rev1 Budget	FY 2026 Rev1 Budget
Gas (MMBtu) Storrs CUP	1,665,387	1,687,385	1,725,659	1,675,148	1,692,454
Electricity (kWh) Storrs CUP	11,127,853	12,524,296	11,469,615	11,826,075	12,156,108
Oil (gallons) Storrs CUP	408,138	285,671	72,806	319,789	285,827
Electricity (kWh) Other Accounts	24,308,143	22,824,021	22,135,715	24,474,068	23,798,937
Gas (MMBtu) Other Accounts	294,429	314,030	330,993	314,289	329,974
<b>Total Energy (MMBtu)</b>	<b>2,137,455</b>	<b>2,161,732</b>	<b>2,181,433</b>	<b>2,157,744</b>	<b>2,184,837</b>



THANK YOU





# ATTACHMENT 7

December 11, 2024

TO: Members of the Board of Trustees

FROM: Jeffrey P. Geoghegan, CPA   
Executive Vice President for Finance & Chief Financial Officer

RE: Cooperation Agreement with Wilhusky Housing LLC concerning development of Site B of off-campus student housing known as The Hub on North Eagleville Road

RECOMMENDATION:

That the Board of Trustees approve the University Administration entering into a Cooperation Agreement and any other ancillary agreements with Wilhusky Housing LLC to facilitate development of Site B of off-campus student housing at the complex currently known as The Hub on North Eagleville Road in Storrs CT. The Administration recommends that the Board of Trustees adopt the Resolution below.

RESOLUTION:

“Be it resolved that the Board of Trustees authorizes the University Administration to enter into a Cooperation Agreement and any other required ancillary agreements with Wilhusky Housing LLC to facilitate development of Site B of off-campus student housing at the complex currently known as The Hub on North Eagleville Road in Storrs CT.”

BACKGROUND:

Wilhusky Housing LLC has received approval from the Town of Mansfield Planning and Zoning Commission to construct student housing totaling approximately 1,350 beds on North Eagleville Road on two separate parcels that bisect the road. The north side of North Eagleville Road will be constructed first (Site B) and start in the spring 2025, while the south half of the development (Site A) will be started in a future year. Site B is bound by University property on all four sides (i.e. University improved land on the west and north sides, a University road on the east side, and a University-controlled road on the south side), so the project cannot be constructed without easements and cooperation from the University.

The Cooperation Agreement has the following pertinent terms:

- The University will enter into four (4) easements to allow the construction of the development on Site B, including temporary use of university-owned land, permanent use and access in the right-of-way along North Eagleville Road, emergency use of LeDoyt Road and permanent easements for drainage. The easements are graphically depicted in Exhibit A.
- The University will cooperate with utility companies looking to serve Site B with electric, gas, water and sewer services.
- The Developer will adjust heights of roof-deck walls to be at least eight feet high
- The Developer will install security and safety systems in the apartment building
- The University will provide overflow parking for the new development (to be charged at university rates)
- The University will coordinate bus service to stop in close proximity to the development
- The University will receive a right of first refusal should the Developer look to sell the development in the future
- The University will receive a lump sum payment of \$600,000 for the easements and \$25,000 (subject to adjustment each five years) for any operating expenses to fulfill the terms of the Cooperation Agreement.

-END-

# ATTACHMENT 8

---

December 11, 2024

TO: Members of the Board of Trustees

FROM: Jeffrey P. Geoghegan, CPA   
Executive Vice President for Finance and Chief Financial Officer

RE: Purchase, Master Lease, Sublease and Escrow Agreement of 1201 Washington Boulevard in Stamford for Student Housing at UConn Stamford

RECOMMENDATION:

That the Board of Trustees authorizes the University Administration to enter into a Purchase and Sale Agreement, Master Lease, Sublease and Escrow Agreement concerning the property at 1201 Washington Boulevard in Stamford CT for the intended use as student residential housing for UConn Stamford. The Administration recommends that the Board of Trustees adopt the Resolution below.

RESOLUTION:

“Be it resolved that the Board of Trustees authorizes the University Administration to enter into a Purchase and Sale Agreement, Master Lease, Sublease and Escrow Agreement and any other necessary legal or ancillary documents concerning the property at 1201 Washington Boulevard in Stamford CT for the intended use as student residential housing for UConn Stamford”.

BACKGROUND:

The University entered into a long-term agreement with RMS Properties for an apartment building in 2016 near UConn Stamford to provide residential housing for the first time at a regional campus. The housing has been extremely successful in assisting the regional campus to grow enrollment. The University has increased its housing supply over the last seven years and currently has 675 beds of housing available for students through a combination of long-term agreements and market rate units. On an individual unit basis, the University makes a small profit on student housing provided through long-term agreements but loses money on market rate units.

The demand for housing has regularly exceeded the University’s stock. The University issued a Request for Expressions of Interest (RFEI) in spring 2024 to solicit proposals to provide housing under long-term agreements. The University received (11) eleven responses and after interviewing and visiting a shortlisted set of properties, determined that the proposal by the Owners of 1201 Washington Boulevard represented the best opportunity.

## THE PROPERTY

1201 Washington Boulevard is a 94-unit existing apartment building located immediately to the north of the main campus building at UConn Stamford. The owners (RMS Properties and Wolff Companies) propose emptying the building from its current occupants over the next approximately two years and leasing the entire building to the University for student housing. With a change to dormitory use, the building has a capacity for approximately 350 beds of student housing. Additionally, the property has 116 parking spaces that will be included in the transaction.

We plan on utilizing the same legal structure as was used in the last long-term agreement transaction at 900 Washington Boulevard in Stamford. The four components are as follows: a) a purchase by the University of the entire parcel for a nominal value, b) a master lease of the property to RMS/Wolff to transfer maintenance and capital obligations, c) a sublease that provides the right of occupancy to the University in exchange for a lease payment, and d) an escrow agreement, which consummates the transaction now, but allows the closing to be in approximately 20 months when the building is emptied. The master lease and sublease are coterminous.

## MATERIAL TERMS

Most of the University's obligations to RMS/Wolff are in the Sublease and include the following:

- The term of the sublease is 25 years commencing July 1, 2026
- The University will have the option of leasing any units that are available in the summer 2025 at a 15% discount to the current market rates. This is estimated at between 100 and 140 beds of housing.
- The first-year base rent will be approximately \$2.89 million
- Rent will escalate at a rate of 2.75% each year thereafter
- RMS/Wolff will have all responsibilities for maintenance and capital repairs for the property
- The University is responsible for utility expenses and any damage to the property
- Public space furniture will be provided by RMS/Wolff
- The University is responsible for furnishing the units
- The property reverts back to RMS/Wolff at the end of the master lease and sublease

Exhibit A includes a photograph of the existing apartment building.

--END--

EXHIBIT A



Existing Apartment Building at 1201 Washington Boulevard, Stamford CT

# ATTACHMENT 9

---



December 11, 2024

TO: Members of the Board of Trustees

FROM: Jeffrey P. Geoghegan, CPA   
Executive Vice President for Finance and Chief Financial Officer

RE: Purchase of 44 Lake Street, Coventry, CT

RECOMMENDATION:

That the Board of Trustees authorizes the University Administration to enter into a Purchase and Sale Agreement in the amount of \$930,000 for the property located at 44 Lake Street in Coventry, CT for the intended use as a boathouse for the UConn Women's Rowing team. The Administration recommends that the Board of Trustees adopt the Resolution below.

RESOLUTION:

“Be it resolved that the Board of Trustees authorizes the University Administration to enter into a Purchase and Sale Agreement and any other necessary legal or ancillary documents to acquire the property at 44 Lake Street in Coventry CT for the sum of \$930,000.”

BACKGROUND:

The current boathouse for the Women's rowing team is located in Patriot's Park in Coventry CT and is occupied under a Facility Use Agreement which expires in December 2026. To address Title IX requirements, the University proposed to demolish and rebuild the existing boathouse. Due to community opposition, the Town of Coventry did not accept the University's proposal and put the project on hold subject to further study. The University sought out other land parcels on the lake in order to guarantee the operation of the rowing team beyond 2026.

44 Lake Street is an existing approximately 10,000 square foot building on Coventry Lake with approximately 150' of water frontage. The property was originally listed at \$1.2 million in 2022, but the purchase price has been negotiated to \$930,000. Lot line adjustments will be made with two adjacent properties as part of the transaction, which will result in approximately 1.25 acres of land and the building being included in the purchase. A conditions survey and preliminary environmental survey have already been conducted and no major concerns were noted. The purchase and sale agreement will have a six-month free due diligence period to attain the permits for a new dock and boathouse improvements. If the closing is not within six months after the execution of the agreement, the University can extend the due diligence period at a cost of \$3,000 per month for up to six additional months.

Exhibit A depicts the lot and building to be purchased at 44 Lake Street in Coventry, CT.  
Exhibit A

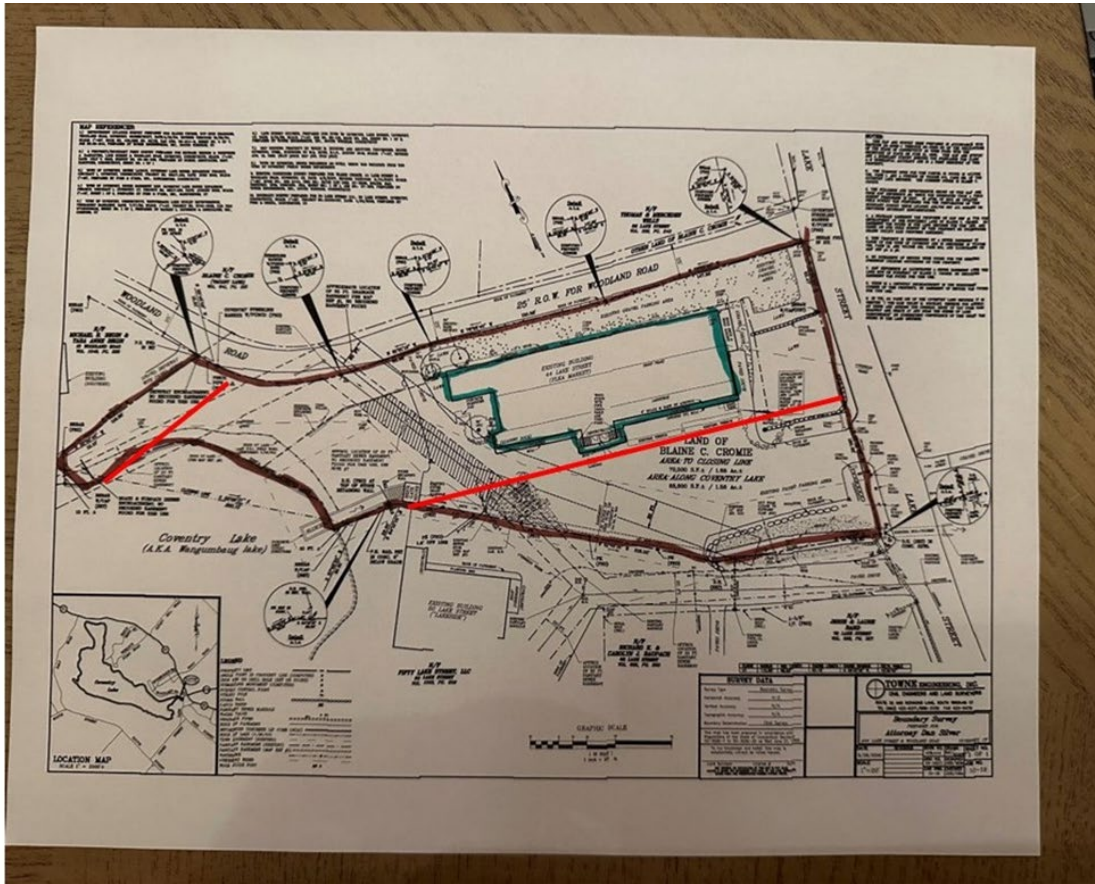

Map of intended 1.25 Lot to be created and purchased at 44 Lake Street, Coventry CT



View of 44 Lake Street from Coventry Lake

# ATTACHMENT 10

---

December 11, 2024

TO: Members of the Board of Trustees 

FROM: Jeffrey P. Geoghegan, CPA  
Executive Vice President for Finance and Chief Financial Officer

RE: Project Budget for Reflection Garden (Design: \$800,000)

RECOMMENDATION:

That the Board of Trustees approve the Design Budget of \$800,000, as detailed in the attached project budget, for the Reflection Garden project, an increase of \$608,670 over the previously approved budget of \$191,330. The Administration recommends that the Board of Trustees adopt the Resolution below.

RESOLUTION:

“Be it resolved that the Board of Trustees approve the use of \$725,000 in Gift Funds, and \$75,000 in University Funds for the Reflection Garden project.”

BACKGROUND:

This project was initiated in 2022 by two friends, active donors, and alumni who envisioned an outdoor space that fosters wellness, inclusivity, tolerance, and peace. In coordination and collaboration with the donors, UConn Foundation, the Provost, the Dean of Students, Global Affairs, Student Life & Enrollment, student leaders, and numerous campus stakeholders, the project will renovate an existing tree and lawn area to a garden space on the east side of Babbidge Library in Storrs.

The design framework was inspired by the Golden Spiral – a logarithmic spiral whose growth factor is  $\phi$ , or the Golden Ratio. That is, a golden spiral gets wider (or further from its origin) by a factor of  $\phi$  for every quarter turn it makes. Found in nature as a shell, a plant, a flower, a human ear, a hurricane or an entire galaxy, the Golden Spiral also symbolizes unity, providing a balance within a world full of diversity and change while fostering harmony, understanding, and peace.

Program elements include hardscape, concrete pavement, specialty pavers, and porous pavement. Plantings include flowering trees, deciduous shade trees, evergreen hedges, flowering shrubs and lawn areas. Site amenities include granite block seat walls with inspirational quotes and separately gifted sculptures positioned in the center of the space named “Contemplation” – an interactive installation that invites people to view themselves, their environment, and others as they experience tranquil surroundings. Site utilities include drainage, lighting and electrical relocations required to complete the project.

The Design Budget and artist renderings are attached for your information.

Attachment

## CAPITAL PROJECT BUDGET REPORTING FORM

**TYPE BUDGET:**            **DESIGN**

**PROJECT NAME:**            **REFLECTION GARDEN**

	<b>APPROVED</b>	<b>PROPOSED</b>
	<b>PLANNING</b>	<b>DESIGN</b>
<b><u>BUDGETED EXPENDITURES</u></b>	<b><u>1/29/2024</u></b>	<b><u>12/11/2024</u></b>
	PRC	
CONSTRUCTION	\$ -	\$ 600,000
DESIGN SERVICES	120,000	70,000
TELECOMMUNICATIONS	-	12,500
FURNITURE, FIXTURES AND EQUIPMENT	-	7,500
CONSTRUCTION ADMINISTRATION	-	15,000
OTHER AE SERVICES (including Project Management)	20,000	5,000
ART	-	-
RELOCATION	-	-
ENVIRONMENTAL	-	5,000
INSURANCE AND LEGAL	5,000	-
MISCELLANEOUS	-	5,000
OTHER SOFT COSTS	-	-
<b>SUBTOTAL</b>	<b>\$ 145,000</b>	<b>\$ 720,000</b>
PROJECT CONTINGENCY 10%	46,330	80,000
<b>TOTAL BUDGETED EXPENDITURES</b>	<b><u>\$ 191,330</u></b>	<b><u>\$ 800,000</u></b>
<b><u>SOURCE(S) OF FUNDING*</u></b>		
GIFT FUNDS	\$ 191,330	\$ 725,000
UNIVERSITY FUNDS	-	75,000
<b>TOTAL BUDGETED FUNDING</b>	<b><u>\$ 191,330</u></b>	<b><u>\$ 800,000</u></b>

\* This budget reflects the University's current intended source(s) of funding for the specified project. The University may adjust this funding plan in order to ensure compliance with applicable federal and state law(s) or to strategically utilize all fund sources, within the approved budget amount, as appropriate.

REFLECTION GARDEN  
Project Budget (DESIGN)  
December 11, 2024



*Site plan and view into Garden*



# ATTACHMENT 11

---



December 11, 2024

TO: Members of the Board of Trustees

FROM: Jeffrey P. Geoghegan, CPA   
Executive Vice President for Finance and Chief Financial Officer

RE: Project Budget for UConn Hartford Café (Final: \$1,100,000)

RECOMMENDATION:

That the Board of Trustees approve the Final Budget of \$1,100,000, as detailed in the attached project budget, for the UConn Hartford Café project for construction an increase of \$900,000 over the previously approved budget. The Administration recommends that the Board of Trustees adopt the Resolution below.

RESOLUTION:

“Be it resolved that the Board of Trustees approve the use of \$1,100,000 in University Funds for the UConn Hartford Café project.”

BACKGROUND:

The UConn Hartford campus is one of four regional campuses in the University of Connecticut system. Limited dining is provided at the other regional campuses, but at UConn Hartford, no dining facilities are currently provided since it was anticipated that food outlets would develop around the campus buildings (but this has not materialized). This project aims to develop a café within the Hartford Times Building, offering students an affordable dining option on-site, address food insecurity, and foster a stronger and more inclusive university community.

The first-floor café will be designed to feature a hot and cold food display, a point-of-sale station, a beverage station, and a selection of pre-made soups, salads, and sandwiches. It will also include built-in seating, flexible loose seating, tables, chairs, and necessary equipment for the service area. Upgrades to mechanical, electrical, plumbing, fire protection, IT, and security systems will be implemented as required by code.

The Final Budget is attached for your information.

Attachment

## CAPITAL PROJECT BUDGET REPORTING FORM

**TYPE BUDGET:**      **FINAL**

**PROJECT NAME:**      **UCONN HARTFORD CAFÉ**

	<b>APPROVED PLANNING 8/28/2023</b>	<b>APPROVED DESIGN 5/28/2024</b>	<b>PROPOSED FINAL 12/11/2024</b>
<b><u>BUDGETED EXPENDITURES</u></b>	<b>PRC</b>	<b>PRC</b>	
CONSTRUCTION	\$ -	\$ -	\$ 700,000
DESIGN SERVICES	85,000	180,000	180,000
TELECOMMUNICATIONS	-	-	25,000
FURNITURE, FIXTURES AND EQUIPMENT	-	-	25,000
CONSTRUCTION ADMINISTRATION	-	-	25,000
OTHER AE SERVICES (including Project Management)	-	-	7,500
ART	-	-	-
RELOCATION	-	-	-
ENVIRONMENTAL	-	-	25,000
INSURANCE AND LEGAL	1,000	1,000	2,500
MISCELLANEOUS	-	-	5,000
OTHER SOFT COSTS	-	-	-
<b>SUBTOTAL</b>	<b>\$ 86,000</b>	<b>\$ 181,000</b>	<b>\$ 995,000</b>
PROJECT CONTINGENCY	14,000	19,000	105,000
<b>TOTAL BUDGETED EXPENDITURES</b>	<b>\$ 100,000</b>	<b>\$ 200,000</b>	<b>\$ 1,100,000</b>
<b><u>SOURCE(S) OF FUNDING*</u></b>			
UNIVERSITY FUNDS	\$ 100,000	\$ 200,000	\$ 1,100,000
<b>TOTAL BUDGETED FUNDING</b>	<b>\$ 100,000</b>	<b>\$ 200,000</b>	<b>\$ 1,100,000</b>

\* This budget reflects the University's current intended source(s) of funding for the specified project. The University may adjust this funding plan in order to ensure compliance with applicable federal and state law(s) or to strategically utilize all fund sources, within the approved budget amount, as appropriate.

# UCONN HARTFORD CAFE

Project Budget (FINAL)

December 11, 2024



Rendering of new café area with food prep, display, and transaction counters.



Rendering of new café area with food prep, display, and transaction counters.

# ATTACHMENT 12

---

December 11, 2024

TO: Members of the Board of Trustees

FROM: Jeffrey P. Geoghegan, CPA   
Executive Vice President for Finance and Chief Financial Officer

RE: Project Budget for Northwest Residential Area – Thermal Comfort Improvements  
(Final: \$6,750,000)

RECOMMENDATION:

That the Board of Trustees approve the Final Budget of \$6,750,000 as detailed in the attached project budget for the Northwest Residential Area – Thermal Comfort Improvements project. This reflects an increase of \$5,950,000 to the previously approved Design budget of \$800,000. The Administration recommends that the Board of Trustees adopt the Resolution below.

RESOLUTION:

“Be it resolved that the Board of Trustees approve the use of \$6,750,000 in University Funds for the Northwest Residential Area-Thermal Comfort Improvements project.”

BACKGROUND:

The Northwest Residential Area is located on the north side of campus adjacent to North Eagleville Road. The Northwest Area houses over 1,200 students and is considered a traditional-style residence community. The intent of this project is to add cooling systems to all residential floors in the buildings to improve the thermal comfort in student rooms to promote the student success journey. Currently, fewer than 40% of the residence halls on the Storrs campus are air conditioned. This project aims to aid in the student success journey by allowing the buildings to be better utilized during the summer months.

The project will convert the buildings to dual temperature with automatic heating/cooling switchover. The ground floor of each building already has some cooling capacity and there are existing underground chilled water lines to each building already. The current project request includes full design and construction of the air conditioning systems for two (2) of the six (6) buildings, and the cost of adding air conditioning to the balance of the buildings will be submitted in a future funding request.

The Final Budget is attached for your information.

**Attachment**

## CAPITAL PROJECT BUDGET REPORTING FORM

**TYPE BUDGET:**       **FINAL**

**PROJECT NAME:**       **NORTHWEST RESIDENTIAL AREA - THERMAL COMFORT  
IMPROVEMENTS**

<u>BUDGETED EXPENDITURES</u>	<u>APPROVED PLANNING 8/13/2024</u>	<u>APPROVED DESIGN 10/30/2024</u>	<u>PROPOSED FINAL 12/11/2024</u>
	PRC		
CONSTRUCTION	\$ -	\$ -	\$ 5,350,000
DESIGN SERVICES	250,000	700,000	800,000
TELECOMMUNICATIONS	-	-	-
FURNITURE, FIXTURES AND EQUIPMENT	-	-	-
CONSTRUCTION ADMINISTRATION	-	-	-
OTHER A/E SERVICES (including Project Management)	-	-	-
ART	-	-	-
RELOCATION	-	-	-
ENVIRONMENTAL	-	-	-
INSURANCE AND LEGAL	-	10,000	10,000
MISCELLANEOUS	-	10,000	10,000
OTHER SOFT COSTS	-	-	-
<b>SUBTOTAL</b>	<b>\$ 250,000</b>	<b>\$ 720,000</b>	<b>\$ 6,170,000</b>
PROJECT CONTINGENCY	30,000	80,000	580,000
<b>TOTAL BUDGETED EXPENDITURES</b>	<b>\$ 280,000</b>	<b>\$ 800,000</b>	<b>\$ 6,750,000</b>
 <b><u>SOURCE(S) OF FUNDING*</u></b>			
UNIVERSITY FUNDS	\$ 280,000	\$ 800,000	\$ 6,750,000
<b>TOTAL BUDGETED FUNDING</b>	<b>\$ 280,000</b>	<b>\$ 800,000</b>	<b>\$ 6,750,000</b>

\* This budget reflects the University's current intended source(s) of funding for the specified project. The University may adjust this funding plan in order to ensure compliance with applicable federal and state law(s) or to strategically utilize all fund sources, within the approved budget amount, as appropriate.

# NORTHWEST RESIDENTIAL AREA – THERMAL COMFORT IMPROVEMENTS

Project Budget (FINAL)

DECEMBER 11, 2024



# ATTACHMENT 13

---



December 11, 2024

TO: Members of the Board of Trustees

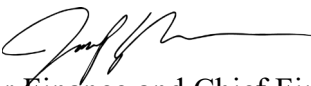
FROM: Jeffrey P. Geoghegan, CPA   
Executive Vice President for Finance and Chief Financial Officer

RE: Project Budget for Whitney Road Steam Improvements E-8 to Q-8  
(Final: \$8,500,000)

RECOMMENDATION:

That the Board of Trustees approve the Final Budget of \$8,500,000, as detailed in the attached project budget, for the Whitney Road Steam Improvements E-8 to Q-8 project, an increase of \$8,300,000 over the previously approved budget of \$200,000. The Administration recommends that the Board of Trustees adopt the Resolution below.

RESOLUTION:

“Be it resolved that the Board of Trustees approves the use of \$8,500,000 in UCONN 2000 Bond Funds for the Whitney Road Steam Improvements E-8 to Q-8 project and approves the request for a waiver of the three-stage budget approval process to allow construction to proceed after bids have been received and evaluated for conformance with the project scope and budget.”

BACKGROUND:

In the fall of 2023, a section of steam pipe adjacent to the South Campus Infrastructure project (beginning at vault E-8 installed under the project) failed and could not be repaired with available materials. This project aims to replace the failed steam line between vaults E-8 and Q-8, along with vault Q-8 itself. This segment is crucial for providing redundant steam to the South Campus area since the other primary steam lines in the area are also in poor condition. The new redundant steam supply will serve the following areas: South Campus Residence Halls, the new Connecticut Residence Hall and Dining Facility, the Fine Arts Complex, and Buckley and Shippee Residence Halls, as well as the future School of Nursing and other future development in the South Campus district.

During design of this work, it was decided to utilize an insulation system that is applied directly over the steam pipes in the field instead of using prefabricated insulated piping. This choice facilitates the future maintenance of the system.

The Final Budget is attached for your information.

**Attachment**

## CAPITAL PROJECT BUDGET REPORTING FORM

**TYPE BUDGET:**       **FINAL**

**PROJECT NAME:**       **WHITNEY ROAD STEAM IMPROVEMENTS E-8 to Q-8**

	<b>APPROVED</b>	<b>PROPOSED</b>
	<b>DESIGN</b>	<b>FINAL</b>
<b><u>BUDGETED EXPENDITURES</u></b>	<b><u>8/13/2024</u></b>	<b><u>12/11/2024</u></b>
	PRC	
CONSTRUCTION	\$ -	\$ 7,000,000
DESIGN SERVICES	175,000	545,000
TELECOMMUNICATIONS	-	-
FURNITURE, FIXTURES AND EQUIPMENT	-	20,000
CONSTRUCTION ADMINISTRATION	-	-
OTHER AE SERVICES (including Project Management)	-	80,000
ART	-	-
RELOCATION	-	-
ENVIRONMENTAL	-	-
INSURANCE AND LEGAL	5,000	5,000
MISCELLANEOUS	-	50,000
OTHER SOFT COSTS	-	-
<b>SUBTOTAL</b>	<b>\$ 180,000</b>	<b>\$ 7,700,000</b>
PROJECT CONTINGENCY	20,000	800,000
<b>TOTAL BUDGETED EXPENDITURES</b>	<b><u>\$ 200,000</u></b>	<b><u>\$ 8,500,000</u></b>
<b><u>SOURCE(S) OF FUNDING*</u></b>		
UCONN 2000 BOND FUNDS	<u>\$ 200,000</u>	<u>\$ 8,500,000</u>
<b>TOTAL BUDGETED FUNDING</b>	<b><u>\$ 200,000</u></b>	<b><u>\$ 8,500,000</u></b>

\* This budget reflects the University's current intended source(s) of funding for the specified project. The University may adjust this funding plan in order to ensure compliance with applicable federal and state law(s) or to strategically utilize all fund sources, within the approved budget amount, as appropriate.

BOT 12.11.24

300281

# WHITNEY ROAD STEAM IMPROVEMENTS E-8 to Q-8

Project Budget (FINAL)

December 11, 2024

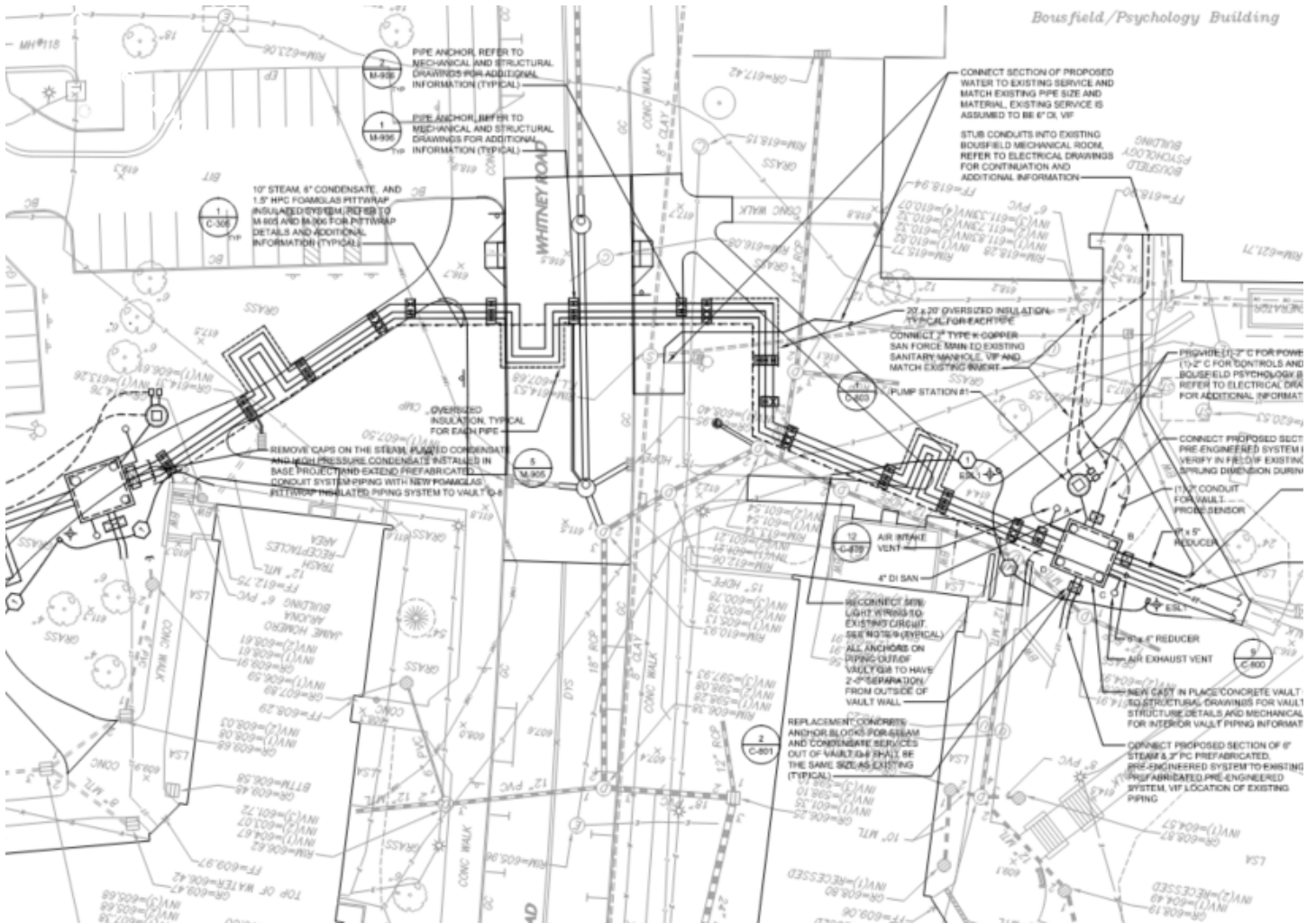

# ATTACHMENT 14

---

December 11, 2024

TO: Members of the Board of Trustees

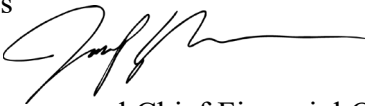
FROM: Jeffrey P. Geoghegan, CPA   
Executive Vice President for Finance and Chief Financial Officer

RE: Project Budget for Coventry Boathouse (Final: \$ 2,650,000)

RECOMMENDATION:

That the Board of Trustees approve the Final Budget of \$2,650,000, as detailed in the attached project budget, for the Coventry Boathouse project for purchase and renovation of the building at 44 Lake Street. This reflects an increase of \$2,270,000 to the previously approved Revised Design budget of \$380,000. The Administration recommends that the Board of Trustees adopt the Resolution below.

RESOLUTION:

“Be it resolved that the Board of Trustees approve the use of \$2,650,000 in University Funds for the Final Phase of the Coventry Boathouse project.”

BACKGROUND:

The University is set to purchase and renovate the existing structure located at 44 Lake Street in Coventry to accommodate the needs of the UConn women's rowing team and promote a sense of Husky Pride amongst team members. The scope of the work will include renovating approximately 4,000 sf of existing space for boat storage and approximately 2,000 sf of finished space for lockers and restrooms. The balance of the space in the approximately 10,000 sf building will remain unfinished and available for future club or other university use. The renovation is required by Title IX requirements and will include providing toilets, showers, lockers, changing areas, and storage for the new rowing boats, modular docks, and launches. The exterior work includes the removal of two small additions to the building which are structurally unsound and providing overhead door access and ramps for the boats.

Work will include new façades at the demolished areas, interior fit-out, finishes, lighting, acoustical improvements, window treatments, and MEP upgrades. In addition to this scope, there will be potential modifications to data and electrical systems, providing HVAC for a portion of the building, and data wiring for card readers.

The design documents are anticipated to be completed for bid in the Spring 2025. The target construction completion date is Summer 2026, which will meet the Title IX improvements deadline. Due to the limited interior finish and HVAC installations, the renovation does not need to meet the High-Performance Building requirements and will not be registered or be able to meet LEED goals.

The Final Budget is attached for your information, which includes the purchase cost and closing costs associated with the purchase of the property.

Attachment

## CAPITAL PROJECT BUDGET REPORTING FORM

**TYPE BUDGET:** FINAL

**PROJECT NAME:** COVENTRY BOATHOUSE

	<b>APPROVED PLANNING 4/4/2022</b>	<b>APPROVED REVISED PLANNING 12/20/2022</b>	<b>APPROVED DESIGN 6/28/2023</b>	<b>APPROVED REVISED DESIGN 9/26/2024</b>	<b>PROPOSED FINAL 12/11/2024</b>
<b><u>BUDGETED EXPENDITURES</u></b>	PRC	PRC	PRC	PRC	
CONSTRUCTION	\$ -	\$ -	\$ -	\$ -	\$ 1,000,000
DESIGN SERVICES	85,000	145,000	165,000	310,000	290,000
TELECOMMUNICATIONS	-	-	-	-	10,000
FURNITURE, FIXTURES AND EQUIPMENT	-	-	-	-	125,000
CONSTRUCTION ADMINISTRATION	-	-	-	-	-
OTHER A/E SERVICES (including Project Management)	-	-	-	-	56,500
ART	-	-	-	-	-
RELOCATION	-	-	-	-	10,000
ENVIRONMENTAL	-	20,000	20,000	30,000	32,500
INSURANCE AND LEGAL	-	-	-	-	20,000
MISCELLANEOUS	5,000	5,000	5,000	5,000	930,000
OTHER SOFT COSTS	-	-	-	-	-
<b>SUBTOTAL</b>	<b>\$ 90,000</b>	<b>\$ 170,000</b>	<b>\$ 190,000</b>	<b>\$ 345,000</b>	<b>\$ 2,474,000</b>
PROJECT CONTINGENCY	10,000	20,000	30,000	35,000	176,000
<b>TOTAL BUDGETED EXPENDITURES</b>	<b>\$ 100,000</b>	<b>\$ 190,000</b>	<b>\$ 220,000</b>	<b>\$ 380,000</b>	<b>\$ 2,650,000</b>
<b><u>SOURCE(S) OF FUNDING*</u></b>					
UNIVERSITY FUNDS	\$ 100,000	\$ 190,000	\$ 220,000	\$ 380,000	\$ 220,000
UCONN 2000 BOND FUNDS	-	-	-	-	2,430,000
<b>TOTAL BUDGETED FUNDING</b>	<b>\$ 100,000</b>	<b>\$ 190,000</b>	<b>\$ 220,000</b>	<b>\$ 380,000</b>	<b>\$ 2,650,000</b>

\* This budget reflects the University's current intended source(s) of funding for the specified project. The University may adjust this funding plan in order to ensure compliance with applicable federal and state law(s) or to strategically utilize all fund sources, within the approved budget amount, as appropriate.

# COVENTRY BOATHOUSE

Project Budget (FINAL)

December 11, 2024





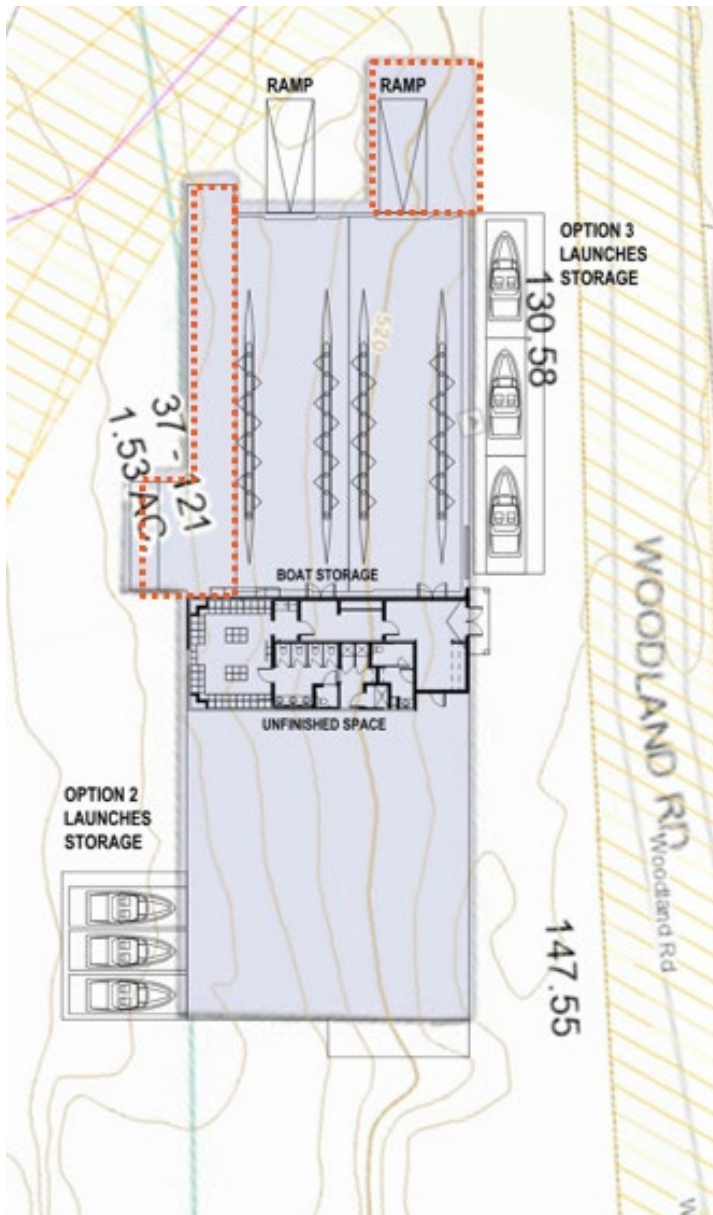

# ATTACHMENT 15

---

December 11, 2024

TO: Members of the Board of Trustees

FROM: Jeffrey P. Geoghegan, CPA   
Executive Vice President for Finance and Chief Financial Officer

RE: Project Budget for Homer Babbidge Library Stairs and Doors  
(Revised Final: \$1,004,300)

RECOMMENDATION:

That the Board of Trustees approves the Revised Final Budget of \$1,004,300 as detailed in the attached project budget, for interior improvements to the Homer Babbidge Library. The Administration recommends that the Board of Trustees adopt the Resolution below.

RESOLUTION:

“Be it resolved that the Board of Trustees approve the use of \$1,004,300 in University Funds for the Homer Babbidge Library Stairs and Doors project and approve the request for a waiver of the three-stage budget approval process to allow construction to proceed in accordance with sole source procurement procedures.”

BACKGROUND:

The project involves three main components:

- Demolition of the existing defunct and decommissioned escalator between the Plaza and Lower Levels and replacement with a bluestone staircase, similar to the work performed one level up in the 1999 interior improvement project.
- Removal and replacement of six storefront doorways at the elevator lobbies on the 2<sup>nd</sup>, 3<sup>rd</sup>, and 4<sup>th</sup> Levels to comply with building code.
- Removal and replacement of the storefront entry doorways at the Plaza Level to comply with energy code.

This project aligns with the strategic initiative Excellence in Research, Innovation, and Engagement.

Attachment

## CAPITAL PROJECT BUDGET REPORTING FORM

**TYPE BUDGET:** REVISED FINAL

**PROJECT NAME:** HOMER BABBIDGE LIBRARY STAIRS AND DOORS

<u>BUDGETED EXPENDITURES</u>	<b>APPROVED FINAL 6/26/2024</b>	<b>PROPOSED REVISED FINAL 12/11/2024</b>
CONSTRUCTION	\$ 638,000	\$ 849,400
DESIGN SERVICES	63,600	63,600
TELECOMMUNICATIONS	-	-
FURNITURE, FIXTURES AND EQUIPMENT	-	-
CONSTRUCTION ADMINISTRATION	-	-
OTHER AE SERVICES (including Project Management)	-	-
ART	-	-
RELOCATION	-	-
ENVIRONMENTAL	-	-
INSURANCE AND LEGAL	-	-
MISCELLANEOUS	-	-
OTHER SOFT COSTS	-	-
<b>SUBTOTAL</b>	<b>\$ 701,600</b>	<b>\$ 913,000</b>
PROJECT CONTINGENCY	70,160	91,300
<b>TOTAL BUDGETED EXPENDITURES</b>	<b>\$ 771,760</b>	<b>\$ 1,004,300</b>
<b><u>SOURCE(S) OF FUNDING *</u></b>		
UNIVERSITY FUNDS	\$ 771,760	\$ 1,004,300
<b>TOTAL BUDGETED FUNDING</b>	<b>\$ 771,760</b>	<b>\$ 1,004,300</b>

\* This budget reflects the University's current intended source(s) of funding for the specified project. The University may adjust this funding plan in order to ensure compliance with applicable federal and state law(s) or to strategically utilize all fund sources, within the approved budget amount, as appropriate.

BOT 12.11.24  
FO502282

# HOMER BABBIDGE LIBRARY STAIRS & DOORS

## Project Budget (REVISED FINAL)

### DECEMBER 11, 2024



# ATTACHMENT 16

---

# UConn HEALTH

December 11, 2024

TO: Members of the Board of Trustees

FROM: Andrew C. Agwunobi, MD, MBA   
Executive Vice President for Health Affairs and CEO of UConn Health

Jeffrey P. Geoghegan, CPA   
Executive Vice President for Finance and Chief Financial Officer

RE: Project Budget for the UConn Health Torrington Clinic Relocation  
(Planning: \$4,800,000)

## RECOMMENDATION:

That the Board of Trustees approve the Planning Budget in the amount of \$4,800,000 for the UConn Health Torrington Clinic Relocation project.

## RESOLUTION:

“Be it resolved that the Board of Trustees approve of the use of \$4,800,000 from UConn Health Capital and a Landlord Fit-out Allowance of approximately \$300,000 for the UConn Health Torrington Clinic Relocation project.”

## BACKGROUND:

Due to space limitations, UConn Health plans to relocate and expand the Torrington clinical practice from 4 examination rooms to 16 examination rooms. The expansion will promote the Wellness of People and Planet and a Stronger, More Inclusive University by increasing community access to the Internal Medicine and extremely busy Multispecialty practices. The medical services provided at the new location will include Internal Medicine, on-site lab and x-ray, and an expansion of specialty services to include Orthopedics, OB, Vascular Surgery, Pulmonary and possibly General Surgery.

The Planning Budget is attached for your consideration. The Planning Budget is based on conceptual estimates and may change as the design is developed. This Planning Budget is anticipated to be approved by the UConn Health Board of Directors at their meeting on December 9, 2024.

Attachments

# **CAPITAL PROJECT BUDGET REPORTING FORM**

**TYPE BUDGET: PLANNING**

**PROJECT NAME: UCONN HEALTH - TORRINGTON CLINICAL PRACTICE  
RELOCATION**

<b><u>BUDGETED EXPENDITURES</u></b>	<b><u>PROPOSED PLANNING 12/11/2024</u></b>
CONSTRUCTION	\$ 2,400,000
DESIGN SERVICES	175,000
TELECOMMUNICATIONS	525,000
FURNITURE, FIXTURES AND EQUIPMENT	1,100,000
CONSTRUCTION ADMINISTRATION	-
OTHER AE SERVICES (including Project Management)	15,000
ART	15,000
RELOCATION	35,000
ENVIRONMENTAL	-
INSURANCE AND LEGAL	-
MISCELLANEOUS	5,000
<b>SUBTOTAL</b>	<b>\$ 4,270,000</b>
PROJECT CONTINGENCY	530,000
<b>TOTAL BUDGETED EXPENDITURES</b>	<b><u>\$ 4,800,000</u></b>
<b><u>SOURCE(S) OF FUNDING*</u></b>	
UCONN HEALTH CAPITAL FUNDS	\$ 4,500,000
LANDLORD FIT-OUT ALLOWANCE	\$ 300,000
<b>TOTAL BUDGETED FUNDING</b>	<b><u>\$ 4,800,000</u></b>

\* This budget reflects the University's current intended source(s) of funding for the specified project. The University may adjust this funding plan in order to ensure compliance with applicable federal and state law(s) or to strategically utilize all fund sources, within the approved budget amount, as appropriate.



UCONN HEALTH/IMPROVEMENTS  
UConn Torrington Clinical Practice Relocation  
Project Budget (Planning) \$4,800,000  
December 11, 2024



**Example Clinical Fit-Out Concept**

# ATTACHMENT 17

---

# UConn HEALTH

December 11, 2024

TO: Members of the Board of Trustees

FROM: Andrew C. Agwunobi, MD, MBA   
Executive Vice President for Health Affairs and CEO of UConn Health

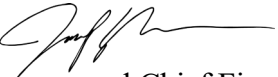
Jeffrey P. Geoghegan, CPA   
Executive Vice President for Finance and Chief Financial Officer

RE: Project Budget for the UConn Health Interventional Radiology Equipment Replacement & Renovation (Design: \$4,700,000)

RECOMMENDATION:

That the Board of Trustees approve the Design Budget in the amount of \$4,700,000 for the UConn Health Interventional Radiology Equipment Replacement & Renovation.

RESOLUTION:

“Be it resolved that the Board of Trustees approves of the use of \$4,700,000 from UConn Health Capital for the UConn Health Interventional Radiology Equipment Replacement & Renovation.”

BACKGROUND:

A Master Plan for the renovation of the Radiology Department located on the Main Level of the Connecticut Tower has been developed to ensure outdated diagnostic radiology imaging equipment can be replaced in a manner that is compliant with current Connecticut Department of Health design/construction guidelines, improve staff workflow and the patient experience. This project will promote and improve the Wellness of People and Planet through the replacement of outdated Interventional Radiology (IR) imaging equipment and renovations of portions of the Radiology Department in accordance with the Master Plan.

The Design Budget is attached for your consideration. The Design Budget is based on consultant estimates and may change based on actual bids received. This Design Budget is anticipated to be approved by the UConn Health Board of Directors at their meeting on December 9, 2024.

Attachments

## CAPITAL PROJECT BUDGET REPORTING FORM

**TYPE BUDGET: DESIGN**

**PROJECT NAME: UCONN HEALTH - INTERVENTIONAL RADIOLOGY EQUIPMENT  
REPLACEMENT & RENOVATION**

<u>BUDGETED EXPENDITURES</u>	<b>APPROVED PLANNING 6/28/2023</b>	<b>PROPOSED DESIGN 12/11/2024</b>
CONSTRUCTION	\$ 1,500,000	\$ 1,675,000
DESIGN SERVICES	200,000	270,000
TELECOMMUNICATIONS	50,000	50,000
FURNITURE, FIXTURES AND EQUIPMENT	2,500,000	2,135,000
CONSTRUCTION ADMINISTRATION	-	-
OTHER AE SERVICES (including Project Management)	-	10,000
ART	-	-
RELOCATION	-	-
ENVIRONMENTAL	20,000	5,000
INSURANCE AND LEGAL	-	-
MISCELLANEOUS	-	10,000
<b>SUBTOTAL</b>	<b>\$ 4,270,000</b>	<b>\$ 4,155,000</b>
PROJECT CONTINGENCY	430,000	545,000
<b>TOTAL BUDGETED EXPENDITURES</b>	<b>\$ 4,700,000</b>	<b>\$ 4,700,000</b>
 <b><u>SOURCE(S) OF FUNDING*</u></b>		
UCONN HEALTH CAPITAL FUNDS	\$ 4,700,000	\$ 4,700,000
<b>TOTAL BUDGETED FUNDING</b>	<b>\$ 4,700,000</b>	<b>\$ 4,700,000</b>

\* This budget reflects the University's current intended source(s) of funding for the specified project. The University may adjust this funding plan in order to ensure compliance with applicable federal and state law(s) or to strategically utilize all fund sources, within the approved budget amount, as appropriate.

UCONN HEALTH/IMPROVEMENTS  
UConn Health Interventional Radiology Equipment  
Replacement & Renovation (Design: \$4,700,000)  
December 11, 2024

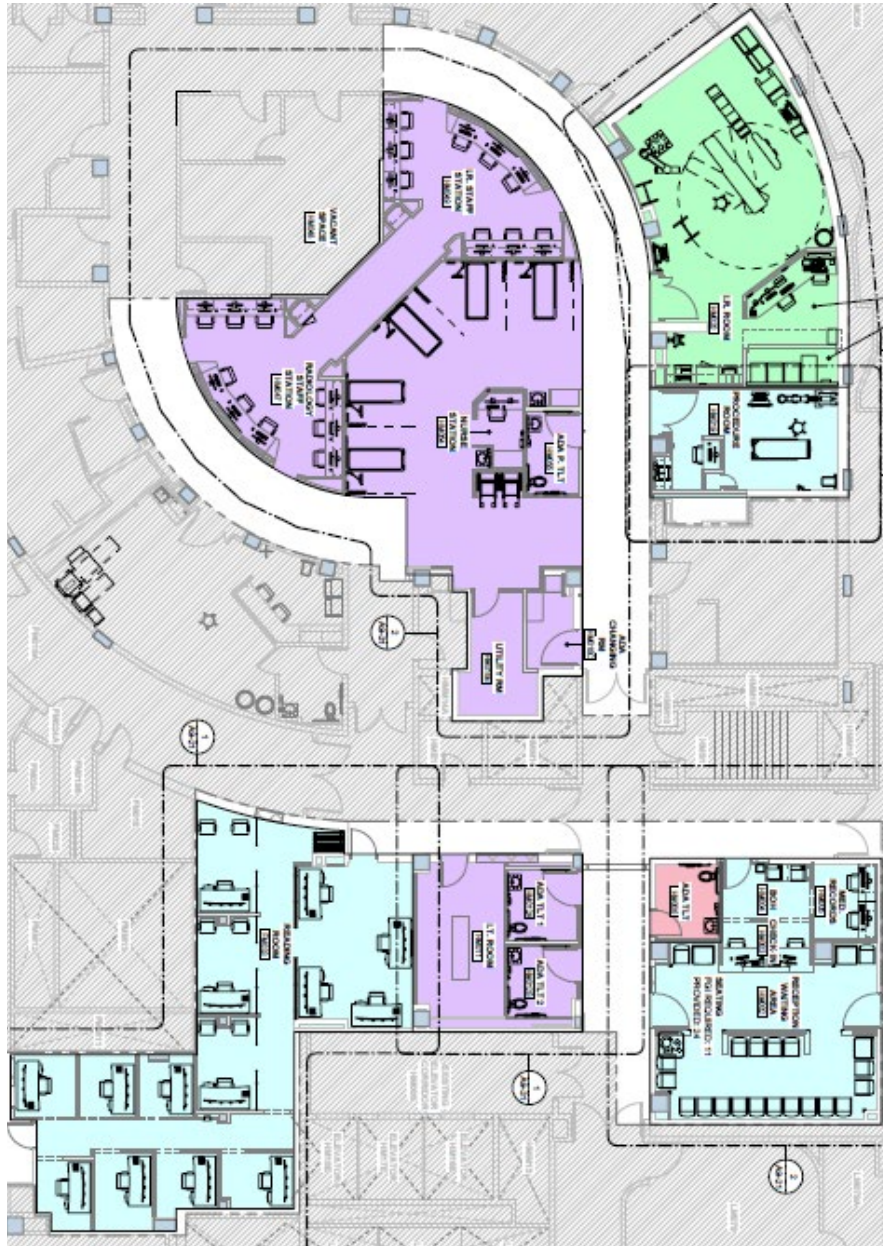

**Radiology Master Plan (proposed renovations in green)**

# ATTACHMENT 18

# UConn HEALTH

December 11, 2024

TO: Members of the Board of Trustees

FROM: Andrew C. Agwunobi, MD, MBA   
Executive Vice President for Health Affairs and CEO of UConn Health

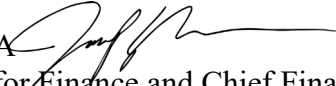
Jeffrey P. Geoghegan, CPA   
Executive Vice President for Finance and Chief Financial Officer

RE: Project Budget for the UConn Health Hybrid OR#2 Fit-Out (Final: \$6,750,00)

## RECOMMENDATION:

That the Board of Trustees approves the Final Budget in the amount of \$6,750,000 for the UConn Health Hybrid OR#2 Fit-Out project.

## RESOLUTION:

“Be it resolved that the Board of Trustees approve of the use of \$6,750,000 from UConn Health Capital for the UConn Health Hybrid OR#2 Fit-Out project.”

## BACKGROUND:

This project will promote and improve the Wellness of People and Planet by creating a second Hybrid Operating Room which allows surgeons to perform a range of procedures in one setting, from minimally invasive treatments to the most complex neurosurgery, interventional cardiology, and vascular procedures by using advanced biplane x-ray imaging equipment that generates high-resolution 3D images of the surgical site.

Under Bioscience CT, the John Dempsey Hospital Operating suite was designed for two Hybrid Operating Rooms. At the time of construction, one Hybrid Operating room was fit-out and one remained as shell space to allow for future expansion. This project will fit-out the shelled area and install a new bi-plane imaging unit to create a 2<sup>nd</sup> Hybrid Operating Room.

The Final Budget is attached for your consideration. The Final Budget is based on actual bids received. This Final Budget is anticipated to be approved by the UConn Health Board of Directors at their meeting on December 9, 2024.

Attachments

# CAPITAL PROJECT BUDGET REPORTING FORM

**TYPE BUDGET: FINAL**

**PROJECT NAME: UCONN HEALTH - HYBRID OR#2 FIT-OUT**

<b><u>BUDGETED EXPENDITURES</u></b>	<b>APPROVED PLANNING 6/28/2023</b>	<b>APPROVED DESIGN 9/25/2024</b>	<b>PROPOSED FINAL 12/11/2024</b>
CONSTRUCTION	\$ 975,000	\$ 975,000	\$ 1,360,000
DESIGN SERVICES	202,000	202,000	202,000
TELECOMMUNICATIONS	30,000	30,000	30,000
FURNITURE, FIXTURES AND EQUIPMENT	4,901,000	4,901,000	4,440,000
CONSTRUCTION ADMINISTRATION	-	-	-
OTHER AE SERVICES (including Project Management)	52,000	52,000	52,000
ART	-	-	-
RELOCATION	-	-	-
ENVIRONMENTAL	-	-	-
INSURANCE AND LEGAL	-	-	-
MISCELLANEOUS	13,000	13,000	13,000
<b>SUBTOTAL</b>	<b>\$ 6,173,000</b>	<b>\$6,173,000</b>	<b>\$ 6,097,000</b>
PROJECT CONTINGENCY	927,000	927,000	653,000
<b>TOTAL BUDGETED EXPENDITURES</b>	<b><u>\$ 7,100,000</u></b>	<b><u>\$7,100,000</u></b>	<b><u>\$ 6,750,000</u></b>
<b><u>SOURCE(S) OF FUNDING*</u></b>			
UCONN HEALTH CAPITAL FUNDS	\$ 7,100,000	\$7,100,000	\$ 6,750,000
<b>TOTAL BUDGETED FUNDING</b>	<b><u>\$ 7,100,000</u></b>	<b><u>\$7,100,000</u></b>	<b><u>\$ 6,750,000</u></b>

\* This budget reflects the University's current intended source(s) of funding for the specified project. The University may adjust this funding plan in order to ensure compliance with applicable federal and state law(s) or to strategically utilize all fund sources, within the approved budget amount, as appropriate.



UCONN HEALTH/IMPROVEMENTS  
UConn Health Hybrid OR#2 Fit-Out  
Budget (Final) \$6,750,000  
December 11, 2024

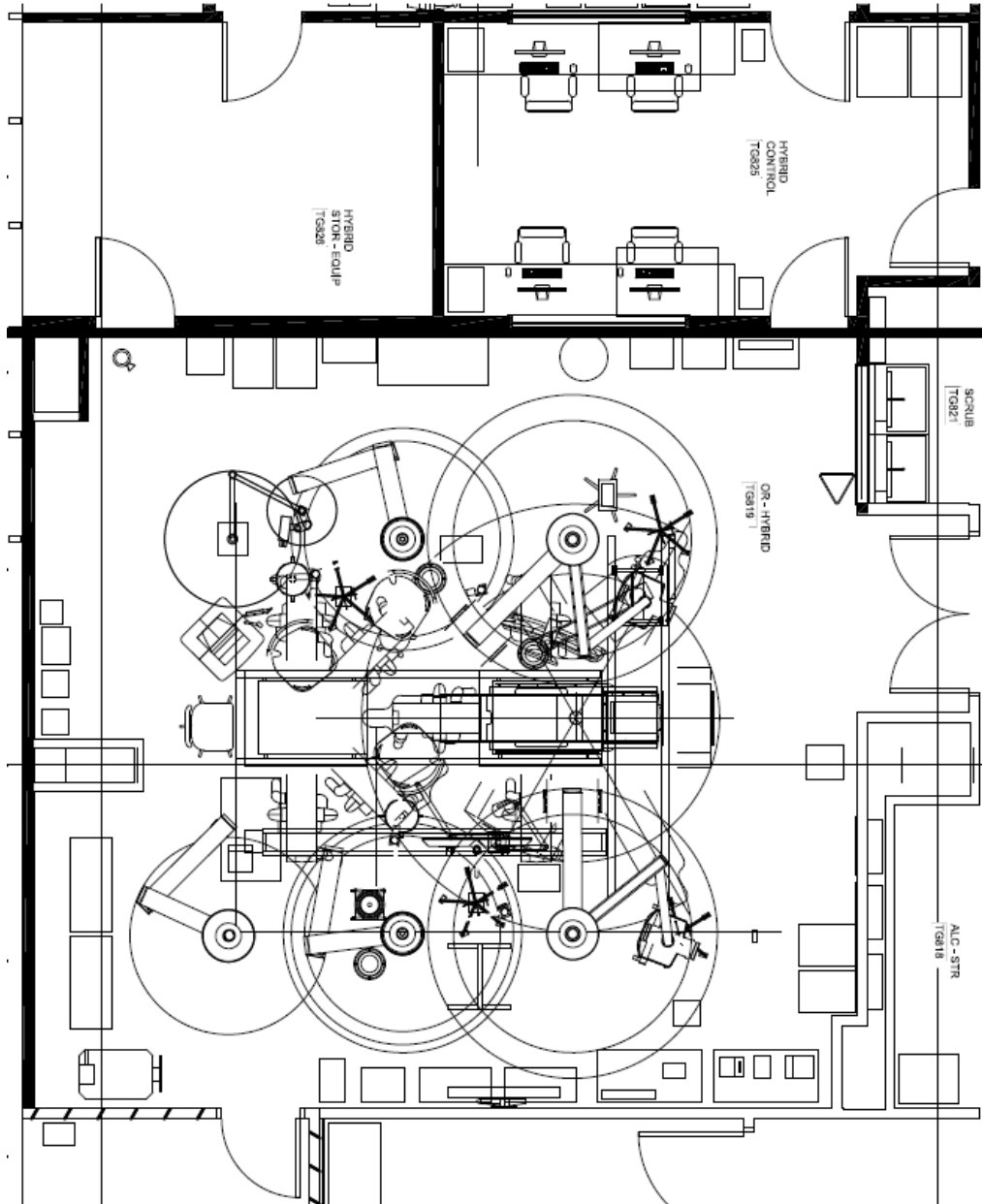

**Conceptual Plan**

# ATTACHMENT 19

---

# UConn HEALTH

December 11, 2024

TO: Members of the Board of Trustees

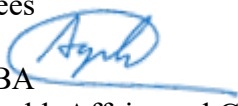
FROM: Andrew C. Agwunobi, MD, MBA   
Executive Vice President for Health Affairs and CEO of UConn Health

Jeffrey P. Geoghegan, CPA   
Executive Vice President for Finance and Chief Financial Officer

RE: Project Budget for the UConn Health New England Sickle Cell Institute  
Renovation (Revised Final: \$5,800,000)

## RECOMMENDATION:

That the Board of Trustees approve the Revised Final Budget in the amount of \$5,800,000 for the UConn Health New England Sickle Cell Institute Renovation Project.

## RESOLUTION:

“Be it resolved that the Board of Trustees approve of the use of \$5,800,000 from UConn Health Capital and UCONN 2000 phase III DM funds for the UConn Health New England Sickle Cell Institute Renovation Project.”

## BACKGROUND:

The New England Sickle Cell Institute (NESCI) and Connecticut Blood Disorders (CBD) clinics were located on an under-utilized inpatient floor within the recently constructed University Tower. In response to the COVID pandemic, these clinics were downsized and relocated to allow for the expansion of inpatient services. This project will promote and improve the Wellness of People and Planet by renovating the 4<sup>th</sup> floor of the Connecticut Tower to accommodate the relocation of the New England Sickle Cell Institute and Connecticut Blood Disorders clinics.

The current estimated cost to complete the project exceeds the previously approved budget by \$530,000. The projected overage is attributed to higher costs to address unforeseen code remediation and failing infrastructure issues, a delay claim by the General Contractor, requirements for additional IT equipment and clinical equipment and furniture required for the administration of infusions.

The Revised Final Budget is attached for your consideration. The Revised Final budget is anticipated to be approved by the UConn Health Board of Directors at their meeting on December 9, 2024.

Attachments

## CAPITAL PROJECT BUDGET REPORTING FORM

**TYPE BUDGET:** REVISED FINAL

**PROJECT NAME:** UCONN HEALTH - NEW ENGLAND SICKLE CELL INSTITUTE RENOVATION

<u>BUDGETED EXPENDITURES</u>	<u>APPROVED PLANNING 6/29/2022</u>	<u>APPROVED DESIGN 6/28/2023</u>	<u>APPROVED FINAL 9/27/2023</u>	<u>APPROVED REVISED FINAL 9/25/2024</u>	<u>PROPOSED REVISED FINAL 12/11/2024</u>
CONSTRUCTION	\$ 2,235,000	\$ 3,645,000	\$ 3,645,000	\$ 3,926,000	\$ 4,610,000
DESIGN SERVICES	128,000	342,000	342,000	355,000	355,000
TELECOMMUNICATIONS	150,000	150,000	150,000	260,000	362,000
FURNITURE, FIXTURES AND EQUIPMENT	199,000	200,000	200,000	406,000	305,000
CONSTRUCTION ADMINISTRATION	-	-	-	-	-
OTHER AE SERVICES (including Project Management)	-	-	-	-	-
ART	15,000	45,000	45,000	45,000	45,000
RELOCATION	-	5,000	5,000	5,000	5,000
ENVIRONMENTAL	-	30,000	30,000	15,000	13,000
INSURANCE AND LEGAL	-	-	-	-	-
MISCELLANEOUS	-	5,000	5,000	7,000	10,000
<b>SUBTOTAL</b>	<b>\$ 2,727,000</b>	<b>\$ 4,422,000</b>	<b>\$ 4,422,000</b>	<b>\$ 5,019,000</b>	<b>\$ 5,705,000</b>
PROJECT CONTINGENCY	273,000	443,000	443,000	251,000	95,000
<b>TOTAL BUDGETED EXPENDITURES</b>	<b><u>\$ 3,000,000</u></b>	<b><u>\$ 4,865,000</u></b>	<b><u>\$ 4,865,000</u></b>	<b><u>\$ 5,270,000</u></b>	<b><u>\$ 5,800,000</u></b>
<b><u>SOURCE(S) OF FUNDING*</u></b>					
UCONN HEALTH CAPITAL FUNDS	\$ 3,000,000	\$ 3,270,000	\$ 3,270,000	\$ 3,270,000	\$ 3,270,000
UCONN 2000 BOND FUNDS	-	1,595,000	1,595,000	2,000,000	2,530,000
<b>TOTAL BUDGETED FUNDING</b>	<b><u>\$ 3,000,000</u></b>	<b><u>\$ 4,865,000</u></b>	<b><u>\$ 4,865,000</u></b>	<b><u>\$ 5,270,000</u></b>	<b><u>\$ 5,800,000</u></b>

\* This budget reflects the University's current intended source(s) of funding for the specified project. The University may adjust this funding plan in order to ensure compliance with applicable federal and state law(s) or to strategically utilize all fund sources, within the approved budget amount, as appropriate.

UCONN HEALTH/IMPROVEMENTS  
UConn Health New England Sickle Cell Institute  
Renovation Project Budget (Revised Final) \$5,800,000  
December 11, 2024

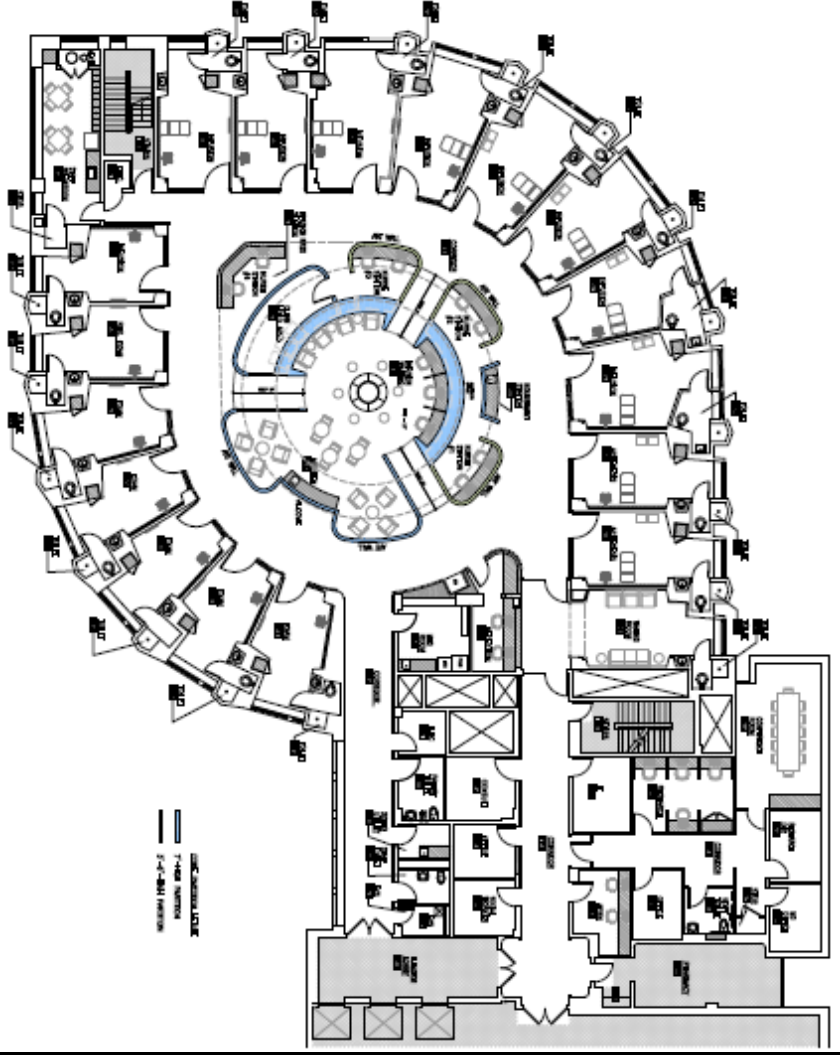

Conceptual Floor Plan

# ATTACHMENT 20

---

**UNIVERSITY OF CONNECTICUT**  
*The Administration is seeking approval to enter into contracts based on the material terms and conditions identified below.*  
**CONTRACTS AND PURCHASE ORDERS OF \$1,000,000 OR MORE**  
**FOR UCONN BOARD OF TRUSTEES APPROVAL ON DECEMBER 11, 2024**

**S/MBE OR CT-Based Coding: S=Small, M=Minority, W=Woman Owned, C= CT-Based									
NEW (Grouped by Family)									
No.	Contractor	Approval Amount	Term	Description/Purpose	Fund Source	UConn Business Owner	Sourcing	Spend to Date	S/MBE/WBE/CT Based
<b>CONSTRUCTION</b>									
1	Mattern Construction, Inc. Contract #300257	\$2,881,803	10/03/24-08/15/25	Project No. 300257 UConn Tennis Facility. Provide general contractor services for the construction of a new building in support of the women's tennis team project located on the Storrs Campus, overseen by the University Planning, Design and Construction department. <b>(Final Budget phase approved by the BOT on 09/25/24 - \$3,450,000)</b>	UCONN 2000	Robert Corbett, Interim AVP, University Planning, Design and Construction	UConn Bid	\$2,881,803	C, S
AMENDMENTS (Grouped by Family)									
No.	Contractor	Approval Amount	Term	Description/Purpose	Fund Source	UConn Business Owner	Sourcing	Spend to Date	S/MBE/WBE/CT Based
<b>CONSTRUCTION</b>									
2	The John Boyle Company, Inc. Contract #OC.FLOOR2021.SBE-6	"No Value Contract"	01/01/21-12/31/25 (No Change)	On-Call Set-Aside Flooring Trade services for all campuses on an as needed basis. This is a no value contract that is being reported for informational purposes to report spend to date for exceeding \$500,000. Zero extensions remain.	Multiple Sources	Stanley Nolan, Interim Associate Vice President Facilities Operations	UConn Bid	\$518,027	C, S
<b>PROFESSIONAL SERVICES</b>									
3	Amenta Emma Architects, P.C. Contract #300260	\$16,760 (Previous Contract Value \$4,202,372; Total New Contract Value \$4,219,132)	10/11/23-Completion (No Change)	Provide additional professional design services for Project 300260 New School of Nursing located at the Storrs Campus, overseen by the University Planning, Design and Construction department. <b>Amend to increase contract value \$16,760, for total new contract value of \$4,219,132.</b> Contract term remains the same. <b>(Design Budget Phase - approved by the BOT - 10/25/23 - \$5,400,000)</b>	UCONN 2000	Robert Corbett, Interim AVP, University Planning, Design and Construction	UConn Bid	\$4,167,757	C, S
4	Payette Associates, Inc. Contract #300050/901802	\$111,503 (Previous Contract Value \$18,613,507; Total New Contract Value \$18,725,010)	12/13/16-12/31/24 (No Change)	Provide additional professional design services for Project 300050/901802 New STEM Research Center - Science 1 located at the Storrs Campus, overseen by the University Planning, Design and Construction department. <b>Amend to increase contract value \$111,503, for total new contract value of \$18,725,010. (Final Budget Phase - approved by the BOT for Project 901802 - 04/29/20- \$220,000,000, Project 300050 - 04/29/20 - \$56,000,000)</b>	UCONN 2000	Robert Corbett, Interim AVP, University Planning, Design and Construction	UConn Bid	\$18,725,010	
5	STV Construction, Inc. Contract #013-PMO-8-NV-043024	"No Value Contract"	05/01/21-04/30/24 (No Change)	Provide continuing project management support services to the Facilities Operations department located at the Storrs Campus, overseen by the Facilities Operations department. This is a no value contract that is being reported for informational purposes to report spend to date for exceeding \$500K. Zero extensions remain. This contract is being used to complete a project currently in process. It has expired and will not be used for any future projects.	Multiple Sources	Stanley Nolan, Interim Associate Vice President Facilities Operations	UConn Bid	\$760,401	
<b>TECHNOLOGY</b>									
6	Teamworks Innovations Inc. Contract # AG5169079	\$98,000 (Previous Contract Value \$552,612; Total New Contract Value \$650,612)	05/26/17-06/30/26 (No Change)	Teamworks software portfolio provides NCAA compliance, nutritional tracking and planning, and recruitment management for Athletics. <b>Amend to increase contract value by \$98,000 for total new contract value of \$650,612.</b> Contract term remains the same. Contract increase is requested to cover the addition of an AMS Inventory Management module in the Teamworks portfolio.	Operating Funds	David Benedict, Director of Athletics	General Letter 71	\$372,499	